



# Z-Style Exhaust system Instruction Manual

( MLIT / JMCA Certified )

Item No. : 0 4 - 0 2 - 2 3 0 6  
Applicable to : Monkey (FI)  
Frame No. : AB27-1900001 ~

Thank you for purchasing one of our TAKEGAWA's products. Please strictly follow the instructions in installing and using the products. Before fitting the products, please be sure to check the contents of the kit. If you have any questions about the products, please kindly contact your local TAKEGAWA dealer.

Before installation, please read this instruction manual carefully and understand the instructions fully.  
Enjoy the distinctive sound and performance with our exhaust system.

Please note: Illustrations and photos may vary from the actual hardware.

## ~ Features ~

Our genuine-style exhaust system can be installed with Monkey's genuine exhaust system guard.

It improves the performance while remaining the original look of the Monkey.

We have adopted our canister body and exhaust pipe, both made of stainless, to improve the appearance and durability.

Our canister with catalyzer passed the Japanese Emission Control, enforced in 2006.

The Japanese MLIT / JMCA certification, enforced in 2010, is acquired.

## Please read the following instructions before installation.

The following show the envisioned possibility of injuries and damages to human bodies, and physical loss or damage as a result of disregarding the following cautions.

We shall be held free from any kind of warranty whatsoever of products other than this product if the glitch takes place on the other products than this one after the installation and use of this product.

This product is designed for exclusive use in the above-mentioned types of motorcycles and frame numbers only. Please take note that this product cannot be mounted on other types of motorcycles.

Please refrain from combined use of this kit with with any other part than the specified parts.

Though a genuine exhaust system guard can be installed as it is, modification to it is necessary as the exhaust system guard and vehicle body may interfere with each other but depending on the slight difference in guard-mounting portion and its parts and vehicle body.

This product is designed for exclusive use with stock kick starter arm. (TAKEGAWA's kick starter arm will interfere with a genuine exhaust system guard.)

Installing the wire-type Dry Clutch Kit (02-02-0143), please use the Hydraulic Clutch Kit (02-02-0144). This product CANNOT be installed with the wire-type Dry Clutch Kit (02-02-0143).



**CAUTION** The following show the envisioned possibility of injuries and damages to human bodies, and property loss as a result of disregarding the following cautions.

- Please drive safely and keep to the traffic regulations.
- Work only when the engine and the exhaust system are cool to avoid getting burn injury.
- Prepare appropriate tools and work properly to avoid the breakage of parts or injuries.
- Always use a torque wrench to tight bolts and nuts securely to the specified torque to avoid these parts getting damaged or loose.
- As some products and frames have sharp edges or protruding portions, work with your hands protected to avoid injuries.
- Do water washing of a exhaust system only when it is cool. (Otherwise, the exhaust system may be cracked.)
- Park your motorcycle in a place where pedestrians will not touch the exhaust system accidentally. Besides, please always be considerate enough not to park it in the way of pedestrians or moving vehicles.  
(If you park your motorcycle on the sidewalk with its exhaust system on the pedestrians' side, the pedestrians may touch the exhaust system and get burned or suffer property loss.)
- Before riding, always check if every screws and bolts are tighten properly.  
(If you find loose ones, screw them securely up to the specified torque to avoid parts coming off.)
- This is designed for exclusive use with stock kick starter arm. TAKEGAWA's kick starter arm CANNOT be used with this product.
- The Japanese MLIT / JMCA Certification is acquired when vehicles are ready for delivery from the manufacturer.

**WARNING**

The following show the envisioned possibility of human death or serious injuries to human bodies as a result of disregarding the following cautions.

- Always drive the engine in a well-ventilated place, and do not switch the engine on in an airtight place.  
(Otherwise, you will suffer from carbon monoxide poisoning.)
- Never look into the exhaust outlet when the engine is running. (Otherwise, you will suffer from carbon monoxide poisoning or lose your sight.)
- When you notice something wrong with your motorcycle, stop riding immediately and park your motorcycle in a safe place to avoid an accident.
- Before riding, be sure to always check the lean angle, and run with care not to lean the vehicle more steeply than the maximum lean angle.  
(Otherwise, there will be a danger of the motorcycle overturning.)
- The engine and the exhaust system are at high temperatures when the engine is running or for a while after the engine stopped. Therefore, never place flammable or hazardous materials such as gasoline near them. (Otherwise, there will be a danger of causing fires.)
- Before working, place the motorcycle on level ground to stabilize its position for safety to avoid the motorcycle overturning.
- Check or perform maintenance of parts correctly according to the procedures in the instruction manual or a service manual.  
(Improper checking or maintenance could lead to an accident.)
- If you find damaged parts when checking and performing maintenance, do not use these parts any longer, and replace them with new ones.  
(The continued use of these damaged parts as they are could lead to an accident.)
- Keep plastic bags for packing products out of children's reach, or discard them.  
(If children get them on, there will be a danger of their suffocating. )
- Basically, you can install this exhaust system in almost the same way as installing a stock exhaust system. Although a genuine exhaust system can be fixed, a guard for an exhaust pipe (right behind the engine exhaust) cannot be installed. So, please do be careful not to let your right leg touch the exhaust pipe when pressing down on the rear brake pedal.  
DO NOT wear loose clothing or sandals when riding on the vehicle. You must wear properly to avoid burns or any accidents.

Please be informed that, because of improvement in performance, design changes, and cost increase, the product specifications and prices are subject to change without prior notice.

We do not have any information or service data on the combination use of our products and other manufacturer's products.

This manual should be retained for future reference.

### ~ Kit Contents ~

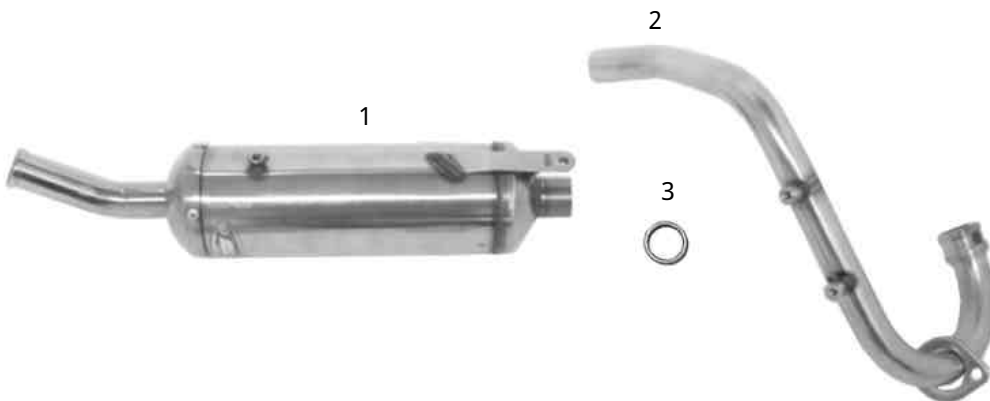

No.	Parts Name	Qty	Repair Part Item No.	In packs of
1	Canister assembly	1	_____	/
2	Exhaust pipe	1	118200-FM1-T00	1
3	Exhaust gasket	1	00-01-0064	2

Please order repair parts with the Repair Part Item No.

Without the repair part item No., we may not be able to accept your orders.

Some parts are only available as a set. In this case, please order them with the set number.

## ~ Installation Procedures ~

Stabilize the vehicle with a maintenance stand or the like in a safe and level place during work.

### Genuine Exhaust System Removal

1. Unfasten two nuts on the exhaust pipe flange. Keep them for re-use.  
If the nuts are worn or damaged severely, replace them with new ones.

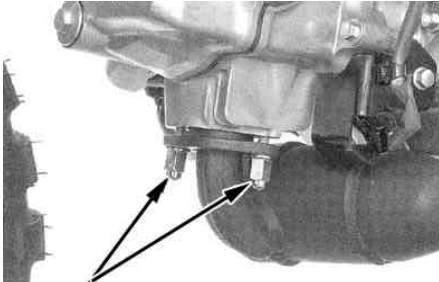

Joint nut

2. Unfasten the hex' bolt which is fixing the exhaust system.

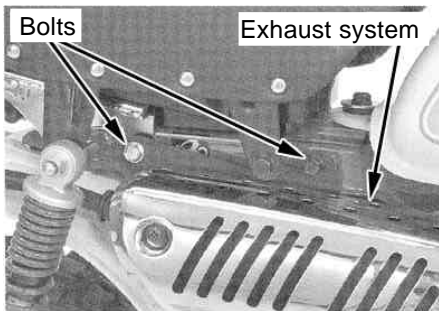

Bolts

Exhaust system

3. Remove the exhaust system from the vehicle body.

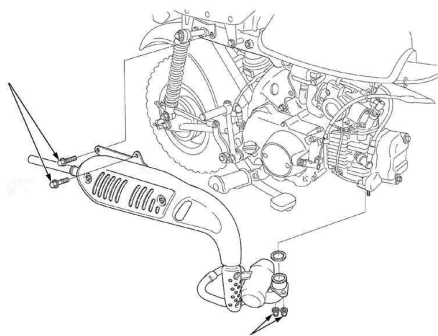

4. Remove the old exhaust pipe gasket if remaining in the exhaust port.

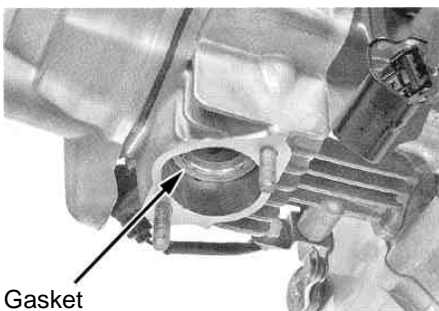

Gasket

### Genuine Exhaust System Guard Removal

1. Detach the exhaust system guard and exhaust pipe guard from the just-removed genuine exhaust system.
2. Unscrew all Philips screws which are fixing the exhaust pipe guard to the exhaust system. Keep those screws for re-use.  
If the screws are worn or damaged severely, replace them with new ones.

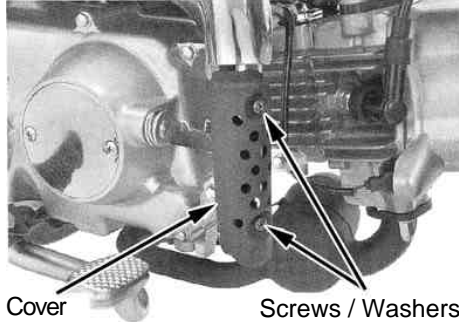

Cover

Screws / Washers

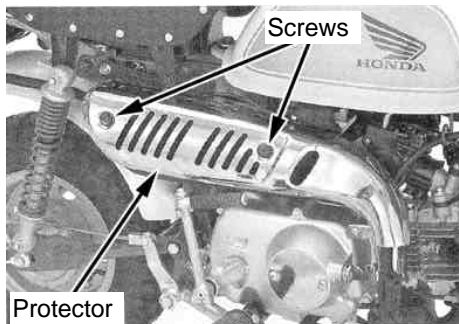

Screws

Protector

⚠ CAUTION: Philips screws may be very tightly screwed, so unscrew them with enough care not to damage their heads.

3. When installing the genuine exhaust system guard, the bracket to equip the exhaust pipe guard can be seen. So cut off the excess of the exhaust system guard as shown in the photo below.



Cut off this part

• If you cut off the excess, we recommend to give a touch-up to the cut surface with a heat-resistant paint to prevent the surface from rusting.

### Z-Style Exhaust System Installation

1. Insert and install the included exhaust pipe gasket to the exhaust port.

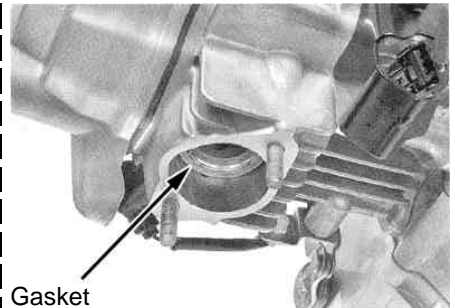

Gasket

2. Temporarily install the canister assembly to the frame. Put the rear end of the canister pipe through behind the upper part of the right-side rear shock absorber and mount the canister pipe temporarily on the frame with a standard bolt.



3. After inserting the exhaust pipe into the joint on the silencer assembly, insert its flange into the engine. We recommend to apply heat-resistant liquid gasket to the inserting portion. (ThreeBond 1207B or the equivalent.)



Apply the liquid gasket here.

- 4 . Put the exhaust pipe flange through the stud bolt of cylinder head and fix it temporarily with the genuine nuts.



- 5 . Check the clearance between the canister's exhaust pipe and the rear fender, and then adjust the positions of the canister and the exhaust pipe so that they do not interfere with each other.



- 6 . Tighten the exhaust pipe flange nuts evenly to the specified torque with care not to let the canister and the exhaust pipe get out of the adjusted places.

**Torque : 12 N · m (1.2 kgf · m)**

⚠Caution: Always keep the specified torque.



- 7 . Then, tighten the standard bolt on the canister bracket to the specified torque.

**Torque : 29 N · m (3.0 kgf · m)**

⚠Caution: Always keep the specified torque.



- 8 . Install the genuine exhaust system guard. To avoid the screws coming off with the vibrations of the vehicle, we recommend to apply the Lock Tight 241 or the equivalent.



- 9 . Install an exhaust pipe cover onto the exhaust pipe in the reverse order of removal. To avoid the screws coming off with the vibrations of the vehicle, we recommend to apply the Lock Tight 241 or the equivalent.



- 10 . Make sure the genuine exhaust system guard, the exhaust system and the frame are all in good condition. If necessary, loosen the screws and nuts on each section to adjust the position of the exhaust system. DO NOT apply unnecessary force. Moreover, when the exhaust system guard, seat bracket and canister interfere with each other, modify or deform the interfering portions to maintain the proper clearance.



- 11 . If a standard kickstarter arm interferes with the exhaust system guard, change the location of the serration until the kickstarter arm does not interfere with the guard, and install the kickstarter arm.

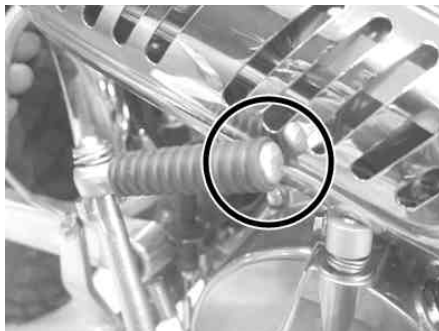

- 12 . Peel the protecting film off the certification plate.

### Final Checking

- 1 . Start the engine in a safe and well-ventilated place, and check for exhaust leak or interference.
- 2 . After stopping the engine and after each part has cooled down to the normal temperatures, re-tighten all screws and nuts to the specified torque.

### Addition

If you have installed our Special Clutch Cover, the exhaust system guard and clutch release arm will interfere. Before installing the exhaust system guard, modify the interfering portions. If you have cut off the interfering portions, we recommend to apply touch-up to the cutting surface with the heat-resistant paint to prevent from rusting.



**SPECIAL PARTS TAKEGAWA Co.,Ltd.**

3-5-16 Nishikiorihigashi Tondabayashi  
Osaka Japan

TEL : 81-721-25-1357 FAX : 81-721-24-5059

URL : <http://www.takegawa.co.jp>