

Auto decompression camshaft instruction manual

SUPER HEAD 4VALVE+R ONLY

Product number	01-08-0449 (10/10D)
	01-08-0067 (15/15D)

Applicable model	GROM · MSX125/SF · Monkey125
	for Super Head 4V+R Cylinder Head

Thank you for your purchase of our product.

The cam shaft is dedicated camshaft to maximize the power of the super head.

By auto decompression device, reduce burden on battery when 4V + R engine start-up. With regard to your use, read manual, please use on always understand protect instruction.

◎ If the description, such as photos or illustration different with this part.

⚠ Caution When the handling of ignoring this display, property damage and human shows the assumption of what injury.

- When performing the work, it should be made to prepare the tools for the job.
(Breakage of parts, it may cause injury.)
- Inspection and maintenance should be done regularly.
(Failure to inspection and maintenance will cause damage to the engine.)
- When carrying out the inspection and maintenance, etc., if found damaged parts, replace the damaged parts to avoid possible to reuse the parts. (There is a risk that lead to accidents Continued use.)

⚠ Warning When the handling of ignoring this display people died, shows the contents of the serious injury possibility is assumed.

- During operation, when an abnormality occurs, immediately stop the vehicle in a safe place, please stop running. (It may lead to an accident.)
- If you start the engine, be sure in a well-ventilated place. In the sealed such place, please do not start the engine. (There is a risk of carbon monoxide poisoning.)
- When performing the work, do the work safely stabilize the vehicle in a horizontal location.
(There is a risk of injury vehicle collapsed while working.)

◎ Please note. Performance up, the design change, the product and the price in the cost up, etc. are subject to change without notice.

◎ Please be informed that we shall be held harmless against any claim against us whatsoever arising out of use of the products in racing and the like.

◎ Keep this manual stored until this product is discarded.

Product content

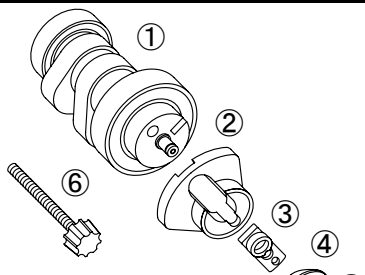

No.	Parts name	Number of use	Repair Item Number
1	Camshaft COMP.	1	10/10D 14104-KYZ-T20
			15/15D 14104-KYZ-T30
2	Weight	1	14103-KYZ-T00
3	Cam sprocket washer	1	14106-SPH-T00
4	Plate	1	14104-KL3-T00
5	Snap ring 6mm	5	00-01-0255 (5 pcs)
6	Knob screw 6x28	1	00-01-0254 (2 pcs)

※ Please order in the repair parts are always repair part number.

If it is not the part number order, you may not be able to order. Please be forewarned.

It should be noted, In the case of parts that can not be separately shipment, please order a set part number.

Please select the appropriate type of cam shaft for your riding purpose.

Notes on use

- ◎ Please be sure to refer to the attachment point of the instruction manual of the super head 4VALVE + R mounting work.
- ◎ No person knowledge and technology, not your work.
- ◎ Refer to the inspection manual of the super head 4V + R, should be periodically checked.

SPECIAL PARTS
TAKEGAWA

CONTACT Address : 3-5-16 Nishikirohigashi Tondabayashi Osaka JAPAN

TEL : +81-721-25-1357 FAX : +81-721-24-5059

e-mail : english@takegawa.co.jp URL http://www.takegawa.co.jp

Please contact with your name and country name provided. (Only English please)