

Super Oil Pump Kit (with relief valve system) Instruction manual

Product number 01-16-0067

Adaptation model	GROM	(JC92-1000001 ~)
	Monkey125	(JB03-1000001 ~)
	Dax 125	(JB04-1000001 ~)
	Super Cub 110	(JA59-1000001 ~)
	Cross Cub 110	(JA60-1000001 ~)
	Super Cub C125	(JA58-1000001 ~)
	Hunter Cub CT125	(JA65-1000001 ~)

Thank you very much for purchasing our products.
Thank you so you will comply with the following matters at the time of use.
Before installation, please check your always kit contents.
If there is a point of notice event, Please contact us the dealer of purchase.

◎ If the description, such as photos or Illustration different with this part.

☆ Please read carefully before use ☆

◎ The use ignoring the instructions that are written in the manual, if the accident or damage has occurred, we can not assume any responsibility for compensation.

◎ This product installation and use, when a problem occurs to after market goods, guarantee other than this product, also can not assume any in any such matters.

◎ If it was the case or mounting that has been processed like a product, it will not be covered under warranty.

◎ It is not possible to inquire of the combination of other manufacturers.

◎ This product is the above-mentioned vehicle exclusive goods.

Please note that even if it is the same name model, it cannot be installed on vehicles other than the above compatible models.

◎ When installing this product, be sure to refer to the genuine service manual for the above applicable vehicle type and perform it securely.

◎ This instruction manual is prepared for those who have basic mechanical skills and knowledge.

If you are not confident about installation or if you do not have the appropriate tools required for installation, please do not install and ask a motorcycle repair shop or certified mechanic for motorcycle repair.

◎ This product does not include the R.crankcase cover gasket, gasket B, and sealing washer (required for installation.)
Please purchase separately.

Genuine No. 11394-K1M-T02 : Gasket, R.crankcase
12396-KRM-840 : Gasket B, Head cover
90407-259-000 : Packing, Drain cock

◎ This product has greatly increased the amount of oil discharged than that stock oil pump. It is effective for vehicles that bore up engine, but it may be necessary to add the amount of oil depending on the motorcycle specifications. In the case of engine specifications that bring higher rev limits such as ECU tuning, etc., we recommend that you refer to the following description.

(It is recommended to take the same action even when using the genuine oil pump.)

Additional oil amount.

- Up to 9,500 rpm : No need to add more oil.
- Over 10,000 rpm : Recommended to add the extra oil + 50cc.
- Over 11,000 rpm : Recommended to add the extra oil + 100cc.

~ feature ~

○ When the oil pressure is increased (by increasing the discharge amount than stock oil pump), oil may leak from the gap between the oil pump body and the cover plate (at high rpm), this makes it impossible to circulate the appropriate discharge amount.

To keep stable oil pressure at high rpm when discharge volume is increased, our oil pump has more number of bolts compare with single bolt(stock) to x 5 bolt, to prevent oil leaks. Also thicker cover to get more rigidity.

○ Our company's oil pump increases the discharge amount + 50% more (compared to the stock), and secures the oil pressure even low idling. This oil pump also equipped the relief valve at the oil passage that opens and responds to the oil pressure change due to the engine rpm increase.

This suppresses an excessive increase in oil pressure, when engine speed rises at cold, suppresses damage to the drive gear, mechanism and sealing, prevents the discharge of more oil than necessary when the engine is running at high speed, suppresses the increase in friction loss, and stabilizes the oil level.

Lubrication passage diagram

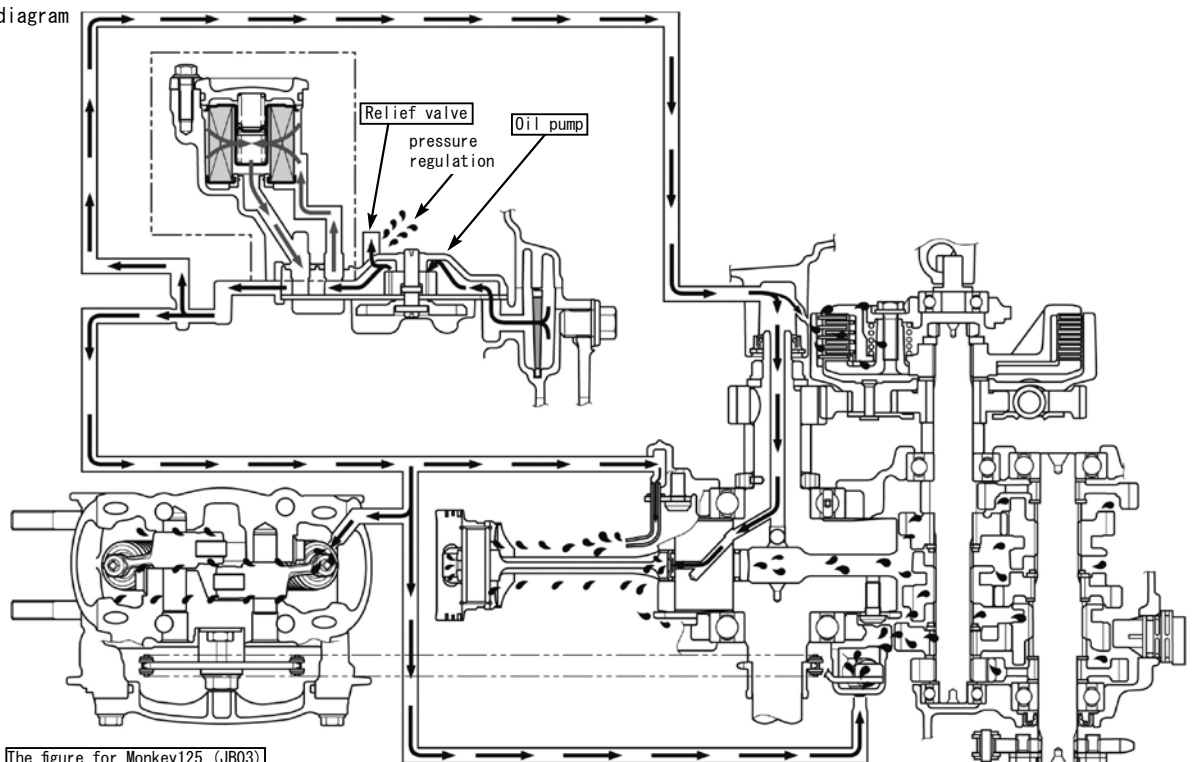

The figure for Monkey125 (JB03)

SPECIAL PARTS
TAKEGAWA

CONTACT Address : 3-5-16 Nishikiorihigashi Tondabayashi Osaka JAPAN
TEL: +81-721-25-1357 FAX: +81-721-24-5059 e-mail: english@takegawa.co.jp URL: http://www.takegawa.co.jp
Please contact with your name and country name provided. (Only English please)

Caution When the handling of ignoring this display, property damage and human shows the assumption of what injury.

- When performing the work, etc., be sure during the cold (when the engine and the muffler is cold). (It may cause burns.)
- When performing the work, it should be made to prepare the tools for the job. (Breakage of parts, it may cause injury.)
- Do the work must always specified torque using a torque wrench. (Damage of bolts and nuts, and cause of dropout.)
- The product and the frame, might have edges or protrusions. Please go to protect your hands when you work. (It may cause injury.)
- Be sure to each part inspection before operation, check the loosening of the threaded portion, be sure to securely tighten the specified torque if there is loose. (It may cause detachment of the parts.)
- Gasket always use new parts. Also, parts can be re-used may be checked, if wear or damage, it is always replaced with new parts.

Warning When the handling of ignoring this display people died, shows the contents of the serious injury possibility is assumed.

- If you start the engine, be sure in a well-ventilated place. In the sealed such place, please do not start the engine. (There is a risk of carbon monoxide poisoning.)
- During operation, when an abnormality occurs, immediately stop the vehicle in a safe place, please stop running. (It may lead to an accident.)
- When performing the work, do the work safely stabilize the vehicle in a horizontal location. (There is a risk of injury vehicle collapsed while working.)
- Inspection, maintenance, the instruction manual or, inspection methods such as service manuals, to protect the way, should be done correctly. (unsuitable inspection and maintenance, there is a risk that result to an accident.)
- When carrying out the inspection and maintenance, etc., if found damaged parts, replace the damaged parts to avoid possible to reuse the parts. (There is a risk that lead to accidents Continued use.)
- Plastic bags of product packaging, you can either be stored in a place that is out of reach of children, it should be discarded. (When the children or wearing, there is a risk of suffocation.)

- ◎ Please note. Performance up, the design change, the product and the price in the cost up, etc. are subject to change without notice.
- ◎ Please be informed that we shall be held harmless against any claim against us whatsoever arising out of use of the products in racing and the like.
- ◎ Keep this manual stored until this product is discarded.

Product content

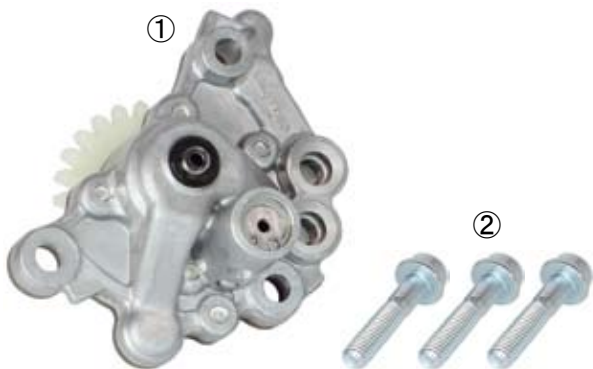

Number	Product content	Quantity	Item Number
1	Oil pump COMP.	1	_____
2	Flange socket cap screw, 6x30	3	00-00-2881 (3 pcs)

※ Please order in the repair parts are always repair part number. If it is not the part number order, you may not be able to order. Please be forewarned. It should be noted, In the case of parts that can not be separately shipment, please order a set part number.

■ Mounting procedure ※ Please refer to the Genuine Service Manual for detailed mounting methods and specified torques that are not specifically described.

- Required for assembly: R. crankcase cover gasket and gasket B.
- Start the engine and warm it up for about 3 to 5 minutes.
- Stop the engine and let it sit for 2-3 minutes.
- Prepare an oil pan under the drain bolt, remove the drain bolt and sealing washer, and drain the engine oil.
- Use a new sealing washer and tighten the drain bolt to the specified torque.

▲ Note: Be sure that you protect specified torque.

Drain bolt
Torque : 24N · m (2.4kgf · m)

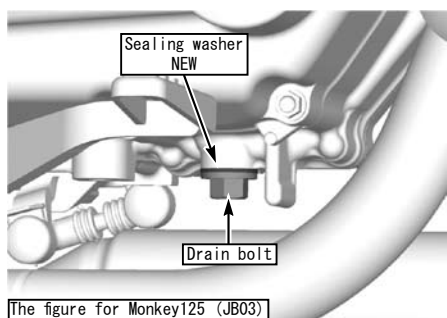

The figure for Monkey125 (JB03)

- ※ Monkey125 / GROM / Dax 125
- Refer to the genuine service manual and remove the R. step holder.

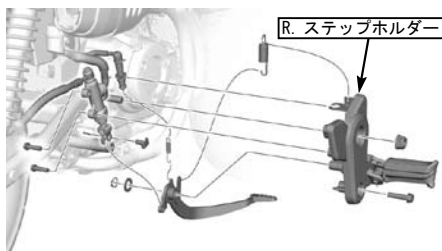

The figure for Monkey125 (JB03)

- ※ Super Cub 110 / Cross Cub 110 / C125 / CT125
- Refer to the genuine service manual and remove the main step.

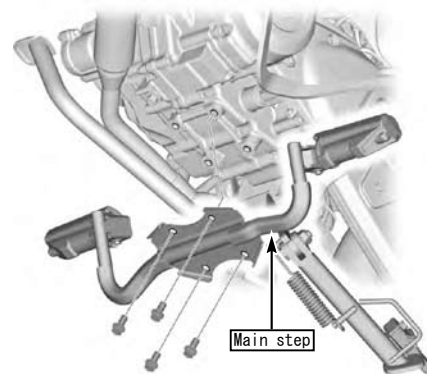

The figure for Cross Cub 110 (JA60)

- ※ Super Cub 110 / Cross Cub 110 / CT125
- Remove kick starter arm.

■ Mounting procedure ※ Please refer to the Genuine Service Manual for detailed mounting methods and specified torques that are not specifically described.

※ The installation procedure is described for Monkey 125 / GROM.

Note: Drawing and photos are not for the Centrifugal clutch models.

- Loosen the screws diagonally several times, remove the right crankcase cover, cover gasket, dowel pin, and gasket B.

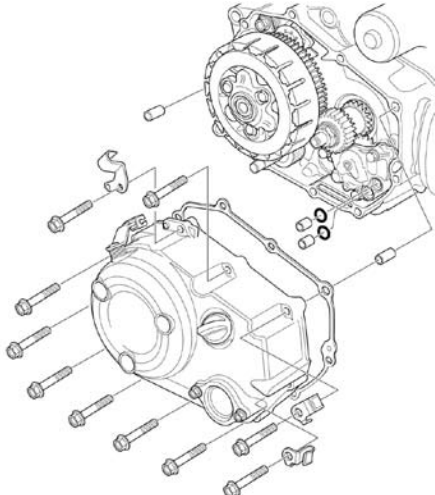

The figure for Monkey125 (JB03)

- Remove the oil strainer, clean the screen, and install the screen with the tapered side facing the crankcase (JB03 shown).

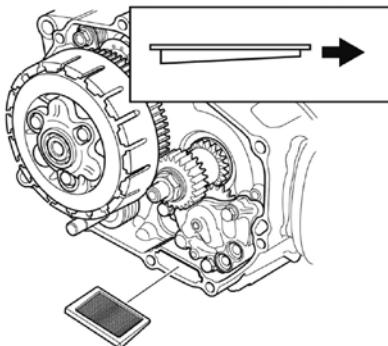

The figure for Monkey125 (JB03)

- Remove the 3 screws holding the oil pump and remove the oil pump.

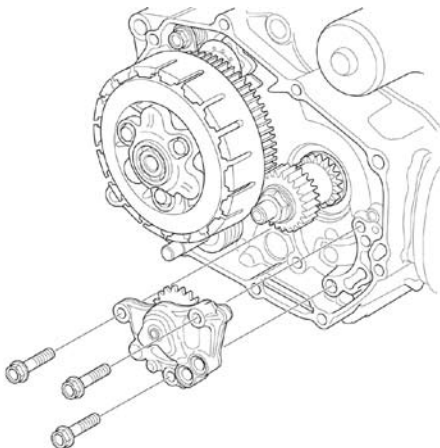

The figure for Monkey125 (JB03)

- Set the dowel pin in the crankcase.



- Pour a small amount of engine oil into the oil passage (back of the oil pump) rotate oil pump gear.

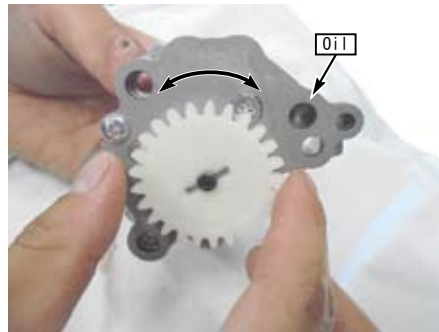

- Engage the gear, attach the oil pump to the crankcase, and tighten it to the specified torque using the flange socket cap screw.

⚠ Note: Be sure that you protect specified torque.

Flange socket cap screw
Torque : 212N · m (1.2kgf · m)



- Place gasket B and dowel pin to oil pump.

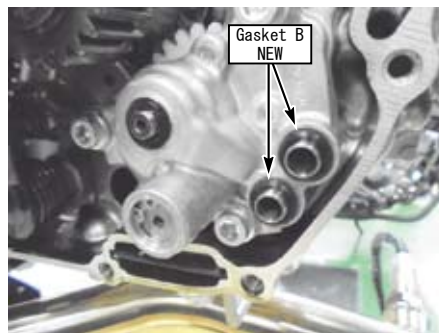

- Wipe off dirt from the mating surfaces of the crankcase, set dowel pins and a new R.crankcase cover gasket, attach it and tighten the screws diagonally in several steps to the specified torque.

⚠ Note: Be sure that you protect specified torque.

Screw
Torque : 10N · m (1.0kgf · m)

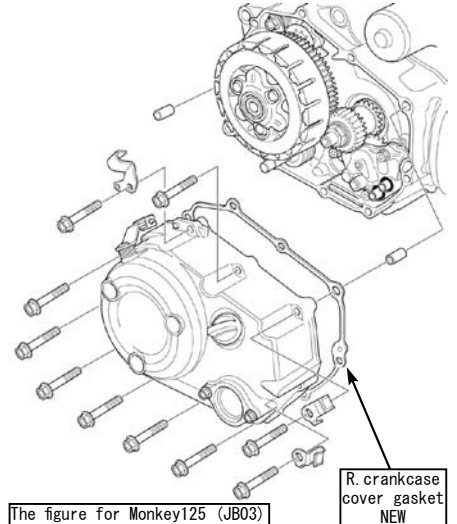

The figure for Monkey125 (JB03)

- Install the removed parts (by referring to the genuine service manual) in the reverse order of removal.

⚠ Note: Follow the instructions in the service manual

- Pour the specified amount of engine oil.
 - Monkey125 / GROM
 - at oil change 0.9ℓ
 - When disassembling the engine 1.05ℓ
 - Super Cub 110 / Cross Cub 110 / C125 / CT125 / Dax 125
 - at oil change 0.8ℓ
 - When disassembling the engine 1.0ℓ
- Start the engine and let it warm up for 3-5 minutes.
- Stop the engine and let it sit for 2-3 minutes.
- Support the vehicle vertically on a flat level surface. According to the oil inspection contents, adjust the amount of oil to the upper level.

⚠ Note: Always refer to the service manual.

- For vehicles that have higher rev limit by ECU tuning, etc., it is recommended to add the extra engine oil by referring to the following when using the high rpm continuously.

- Up to 9500 rpm : No need to add more oil.
- Over 10,000 rpm: Recommended to add the extra oil + 50cc.
- Over 11,000 rpm: Recommended to add the extra oil + 100cc.

※ Checking the oil level by gauge and the oil check window when the amount is increased as a guideline. It is recommended to measure the amount to be increased. (100cc increase level guideline)

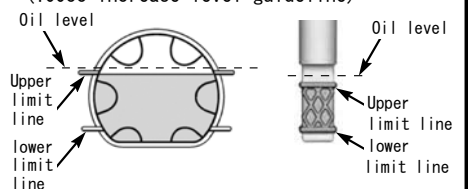

- Wipe off the dirt attached during work.