

Special Clutch Cover Kit (Hydraulic type) Instruction manual

Product number	02-01-0321 (Black paint)
	02-01-0311 (Silver paint)

Adaptation model	Monkey 125 (JB02-1000001 ~)
------------------	------------------------------

Thank you very much for purchasing our products.

Thank you so you will comply with the following matters at the time of use. Before installation, please check your always kit contents. If there is a point of notice event, Please contact us the dealer of purchase.

◎ If the description, such as photos or Illustration different with this part.

☆ Please read carefully before use ☆

- ◎ The use ignoring the instructions that are written in the manual, if the accident or damage has occurred, we can not assume any responsibility for compensation.
- ◎ This product installation and use, when a problem occurs to after market goods, guarantee other than this product, also can not assume any in any such matters.
- ◎ If it was the case or mounting that has been processed like a product, it will not be covered under warranty.
- ◎ It is not possible to inquire of the combination of other manufacturers.
- ◎ This product is the above-mentioned vehicle exclusive goods. Is not possible attached to the other vehicle. Please note.
- ◎ Product may have edges or protrusions. Be sure to wear working gloves.
(Please wear work gloves when working, even if a photo in this article show without work gloves.)
- ◎ Please refer to the genuine service manual for the above-mentioned compatible models for the assembly work.
- ◎ Special tools are required to install this product. Please prepare separately.
Lock nut wrench : 07916-6390001 (Genuine Honda tool) or Lock nut wrench : 00-01-0152 (Takekawa tool)
Gear holder : 07724-0010100 (Genuine Honda tool) or Universal holder : 00-01-1002 (Takekawa tool)
- ◎ When using the sidemirror, an M8 size mount type is required.
- ◎ Anodic oxide coating products there is a case in which fading occurs in color aging. Please note.

~ feature ~

- The hydraulic clutch system improves response and clutch operation.
- R. Crank case cover is made of black painted aluminum die cast, clutch cover is made of billet aluminum and anodized.
- By adopting a paper cartridge oil element, the centrifugal oil filter can be removed and reducing the load on the crankshaft and improving engine response.
- Thermostat unit (02-01-5052: optional) can be installed. Thermostat prevents overcooling with oil cooler.
- The oil level window makes it easy to check the oil level.
- Filtered oil flows through the oil element by two passage (crankshaft / transmission) with this kit.
(In the stock clutch cover, only one crankshaft passage passes through the centrifugal filter from oil pump).
- ※ By connecting our bore-up cylinder (oil outlet equipped model) and oil line hose kit (00-07-0095: optional), the oil through the oil element can flow to the cylinder head.
- Clutch cover for stock clutch or Takekawa slipper clutch.
In addition, it is possible to upgrade to a clutch cover that supports heavy duty clutches (wet or dry) by installing optional items.

 **Caution** When the handling of ignoring this display, property damage and human shows the assumption of what injury.

- On the street, keep the legal speed and obey the traffic law.
(If you drive faster than the legal speed, you will be punished for violating the Road Traffic Act and overspeeding.)
- When performing the work, etc., be sure during the cold (when the engine and the muffler is cold). (It may cause burns.)
- When performing the work, it should be made to prepare the tools for the job. (Breakage of parts, it may cause injury.)
- Do the work must always specified torque using a torque wrench. (Damage of bolts and nuts, and cause of dropout.)
- The product and the frame, might have edges or protrusions. When working, please wear work gloves to protect your hands.
(It may cause injury.)
- Be sure to each part inspection before operation, check the loosening of the threaded portion, be sure to securely tighten the specified torque if there is loose. (It may cause detachment of the parts.)

 **Warning** When the handling of ignoring this display people died, shows the contents of the serious injury possibility is assumed.

- The technology and those who no knowledge, please do not to work. (The cause of parts damage etc., could result in falls and accidents.)
- If you start the engine, be sure in a well-ventilated place. In the sealed such place, please do not start the engine.
(There is a risk of carbon monoxide poisoning.)
- During operation, when an abnormality occurs, immediately stop the vehicle in a safe place, please stop running. (It may lead to an accident.)
- When performing the work, do the work safely stabilize the vehicle in a horizontal location.
(There is a risk of injury vehicle collapsed while working.)
- Inspection, maintenance, the instruction manual or, inspection methods such as service manuals, to protect the way, should be done correctly. (unsuitable inspection and maintenance, there is a risk that result to an accident.)
- When carrying out the inspection and maintenance, etc., if found damaged parts, replace the damaged parts to avoid possible to reuse the parts. (There is a risk that lead to accidents Continued use.)
- The engine and exhaust system are hot while the engine is running or for a while even the engine is stopped. Never place dangerous or flammable materials such as gasoline near working area. (May caused fire.)

- ◎ Please note. Performance up, the design change, the product and the price in the cost up, etc. are subject to change without notice.
- ◎ Please be informed that we shall be held harmless against any claim against us whatsoever arising out of use of the products in racing and the like.
- ◎ Keep this manual stored until this product is discarded.

SPECIAL PARTS
TAKEGAWA

CONTACT Address : 3-5-16 Nishikiorihigashi Tondabayashi Osaka JAPAN
TEL: +81-721-25-1357 FAX: +81-721-24-5059 e-mail: english@takegawa.co.jp URL: http://www.takegawa.co.jp
Please contact with your name and country name provided. (Only English please)

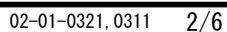

Product content

Number	Product content	Quantity	Item Number
1	R.crankcase cover ASSY.	1	00-02-6208 (Black) 00-02-0466 (Silver) Discontinued product
2	Oil pot window set	1	00-02-0031
3	Thermostat hole cap	1	00-07-0063 (with O-ring)
4	O-ring, 15mm	1	00-00-0185 (5 pcs)
5	Hole cap	1	09-06-0131 (with O-ring)
6	O-ring, 30mm	1	00-01-0034 (4 pcs)
7	Oil plug bolt	3	00-07-0072 (with Sealing washer)
8	Sealing washer, 10mm	6	00-07-0106 (10 pcs)
9	Flange bolt, 6x12	1	00-00-0322 (6 pcs)
10	Sealing washer, 6mm	2	00-00-2780
11	Oil filler cap	1	00-02-0468 (with O-ring)
12	O-ring, 13mm	1	00-00-0644 (5 pcs)
13	Clutch cover	1	02-01-0198 (Black) 02-01-0316 (Silver)
14	Release spring	1	00-00-1096
15	O-ring, 30mm (SBR)	1	00-00-0673
16	O-ring, 30mm (NBR)	1	00-00-0674 (4 pcs)
17	Release piston	1	00-02-0171 (with O-ring)
18	Brake hose (960mm)	1	00-06-0164
19	Adaptor, 10mm	1	00-07-0032 (with Sealing washer) (2 pcs)
20	Banjo bolt M10x1.25 (Gold)	1	00-07-0131 (with Sealing washer)
21	Banjo (Straight)	1	00-07-0006
22	Bleeder cap	1	00-02-6212
23	Bleeder screw	1	00-02-6213
24	Oil filter spring	1	00-07-0065
25	Oil filter element	1	00-02-0027
26	O-ring, 40mm	1	00-02-0040
27	Oil filter cover	1	00-02-0470 (with O-ring/Bolt)
28	Boll bearing, 6001Z	1	00-01-1011
29	C type ring, 28mm	1	00-00-0643 (3 pcs)
30	O-ring, 12mm	1	00-00-0136
31	Oil through nut	1	00-00-2310
32	Conical spring washer, 14mm	1	00-02-0036
33	Spacer	1	00-00-1414
34	Clutch release rod, 10mm	1	00-00-1684
35	Clutch release rod, 12mm	1	00-00-1685
36	Orifice	1	00-00-1072
37	R.crankcase cover gasket	1	00-02-0356
38	O-ring, 120mm	1	00-02-0188
39	Dowel pin, 8x12	2	00-00-0153 (2 pcs)
40	Flange bolt, 6x16	2	00-00-0879 (5 pcs)
41	Flange bolt, 6x35	1	00-00-0885 (5 pcs)
42	Hexagon socket head cap screw (low head), 6x16	4	00-00-0377 (4 pcs)
43	Hexagon socket head cap screw (extremely low head), 6x8	1	00-00-0697 (4 pcs)
44	φ 4 male connector	3	00-00-0570 (each 5 pcs)
45	φ 4 female connector	3	
46	Male connector cover	2	
47	Female connector cover	2	
48	Zip-tie, 200mm	2	00-00-0179 (10 pcs)
49	Brake fluid, DOT4 (200cc)	1	06-08-0019
50	Clutch master cylinder ASSY.	1	02-02-2103
51	Flange bolt, 6x40	9	00-00-0886 (5 pcs)
52	Hexagon bolt, 8x45	1	00-00-0914
53	U nut, M12x1.25	1	00-00-0915
54	Coller 1	1	00-00-2594
55	Coller 2	1	00-00-2595
56	Plain washer, 8mm	1	00-00-0076 (10 pcs)
57	Shim ring, 12x18x0.5	1	00-00-0370

※ Please order in the repair parts are always repair part number. If it is not the part number order, you may not be able to order.

Please be forewarned. It should be noted, In the case of parts that can not be separately shipment, please order a set part number.

※ Repair parts may differ slightly from the kit contents in terms of shape, etc. There is no problem to use it. Please be forewarned.

- Park the motorcycle in a horizontal place with a maintenance stand, etc.
- Drain engine oil.
- Remove the R. step holder.

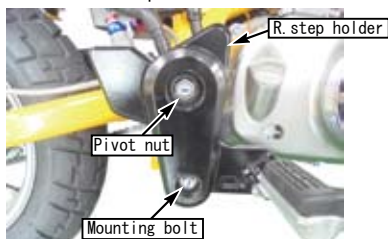

- Disconnect clutch cable.
- Loosen the bolts of the R. crankcase cover several times diagonally and remove the R. crankcase cover and clamp.



- Remove R. crankcase cover gasket, dowel pin and orifice.

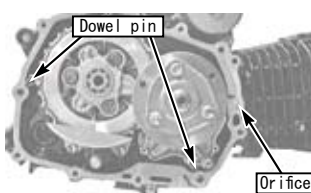

- Remove the bolt, centrifugal oil filter cover and gasket.

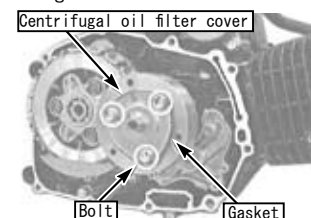

- Hold the primary drive gear and driven gear or the centrifugal oil filter rotor, and remove the centrifugal filter rotor lock nut using a special tool.

Special tool

: Genuine Honda tool
Lock nut wrench 07916-6390001
Gear holder 07724-0010100

: Takekawa tool
Lock nut wrench 00-01-0152
Universal holder 00-01-1002

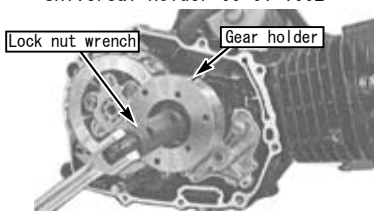

- Remove washers and centrifugal filter rotor.



- Attach the O-ring(12mm) to the oil through nut and apply a engine oil to the O-ring (12mm).

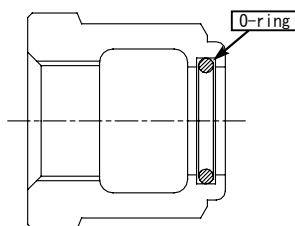

- Attach the spacer, conical spring washer (14mm), and oil through nut to the crankshaft in this order, hold the spacer with a spanner, and tighten the oil through nut to the specified torque.

⚠ Note: Be sure that you protect specified torque.
Oil through nut
Torque : 64N · m (6.6kgf · m)

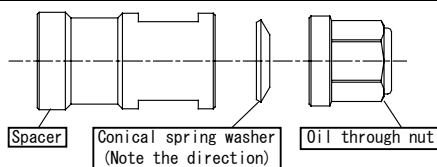

Installing the clutch cover

- Clean the gasket surface of the R. crankcase, attach the dowel pin, and install a new R. crankcase cover gasket.
- Attach the orifice in the kit to the back of the R. crankcase cover.

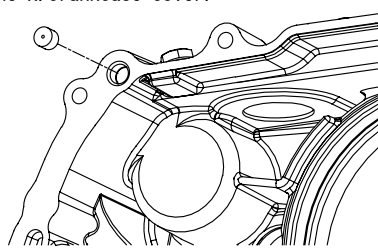

- Attach R. Crankcase cover and clamp with flange bolt and flange bolts, divide bolts several times diagonally and tighten to specified torque.
(Use the kit flange bolts (6x35) at the locations shown by the arrows in the figure below)

⚠ Note: Be sure that you protect specified torque.
Flange bolt 6x35, 6x40
Torque : 9.8N · m (1.0kgf · m)

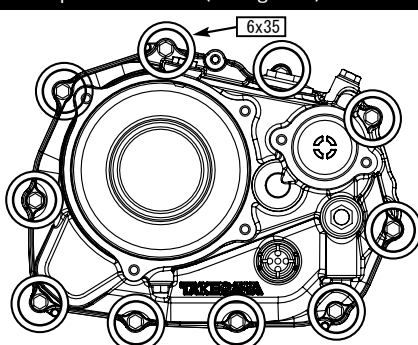

- Attach the lifter rod in the kit to the ball bearing on the clutch lifter plate.
※ Use 10mm lifter rod for stock clutch, 12mm lifter rod for Takegawa slipper clutch.



- Assemble the O-ring 30mm (SBR / NBR) to the release piston then attach the release spring.
※ Apply a thin layer of rubber grease to the O-ring then assemble.
※ Each O-ring has a specified mounting position. As shown in the photo, install the O-ring (SBR) on the spring side and the O-ring (NBR) on the clutch side.

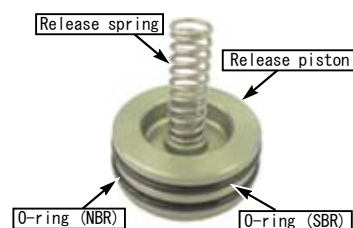

- Attach the assembled release piston to the clutch cover.
※ Apply a thin coat of rubber grease to the cylinder side of the clutch cover and assemble it.
※ Caution: forcibly assemble the release piston into the cylinder, the O-ring will be damaged.



- Attach the O-ring(120mm) to the clutch cover and apply a engine oil to the O-ring(120mm).

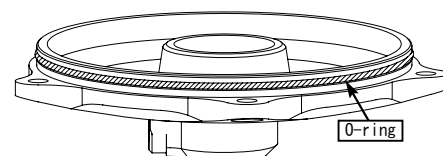

■ Mounting procedure ※ Please refer to the Genuine Service Manual for detailed mounting methods and specified torques that are not specifically described.

- Attach the clutch cover to the R.crankcase cover, install it with the Hexagon socket head cap screw(low head) (6x16) and tighten it to the specified torque.

⚠ Note: Be sure that you protect specified torque.
Hexagon socket head cap screw (low head), 6x16
Torque : 9.8N · m (1.0kgf · m)

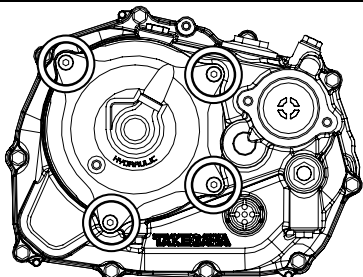

- Insert 6x8 hexagon socket head bolt (extremely low head) with 6mm sealing washer, attach to clutch cover, and tighten with specified torque.

⚠ Note: Be sure that you protect specified torque.
Hexagon socket head cap screw (extremely low head), 6x8
Torque : 6.3N · m (0.64kgf · m)

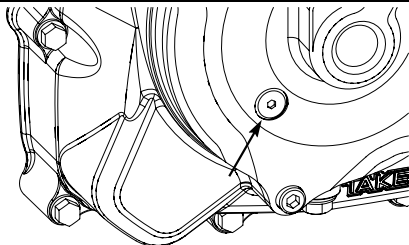

- Attach the bleeder screw (with rubber cap) temporarily, then attach the adaptor with aluminum sealing washer (10mm) to the clutch cover with the specified torque.

⚠ Note: Be sure that you protect specified torque.
Adaptor 10mm
Torque : 12.7N · m (1.3kgf · m)

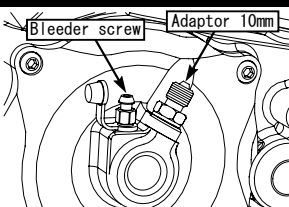

- Remove the connector and switch cover from the clutch lever, and remove the lever from the handle bar.



- With the "UP" mark on the bracket facing upward, attach the master cylinder assembly, and tighten the flange bolts (in the order of upper and lower) with the specified torque.

⚠ Note: Be sure that you protect specified torque.
Flange bolt
Torque : 11.8N · m (1.2kgf · m)



- Attach the brake hose (960 mm) with hold the adaptor (by wrench as shown), and tighten the hose fitting to the specified torque. Route the brake hose (960 mm) to the clutch master cylinder, sealing washer (10 mm), banjo (straight), sealing washer (10mm) in order, install with banjo bolt (M10x1.25, gold), and hose. Tightening with the specified torque.

⚠ Note: Be sure that you protect specified torque.
Banjo bolt
Torque : 14.7N · m (1.5kgf · m)
Hose fitting
Torque : 5.9N · m (0.6kgf · m)



- Cut the wiring of the connector (removed from the stock clutch lever) and the wiring of the clutch master cylinder ASSY. with electrical connector.

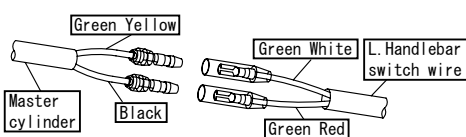

Installing the oil filter cover

- Place the oil filter spring in the R.crankcase cover (fit it into the guide of the case), put the oil filter element, attach the O-ring (40mm) to the oil filter cover, apply engine oil, and attach the flange bolt (6x16). Tighten with specified torque.

⚠ Note: Be sure that you protect specified torque.
Flange bolt, 6x16
Torque : 9.8N · m (1.0kgf · m)

※ Make sure the oil filter element attached the guide on the oil filter cover.

※ Caution: If the oil filter spring does not fit inside of the guide (of the oil filter element), there will be a gap between the oil filter cover and the R.crankcase cover. This may cause the oil leaks.

⚠ Note: Caution: O-ring is installed incorrectly, the engine may be damaged.

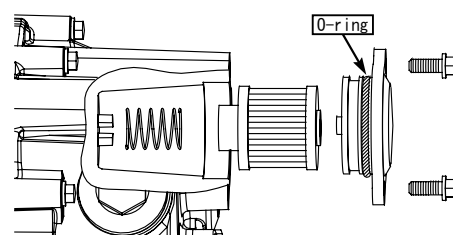

Fill the brake fluid

- Remove the reservoir cap and check that the bleeder screw and banjo bolt are well tightened. Check and fill the brake fluid to the upper limit line of the reservoir and operate the clutch lever to fill the brake fluid in the clutch system.

Repeat this until no air bubbles come out from the primary port in the reservoir (until the clutch lever feels some weight).

※ To prevent chemical reaction, do not mix different brands of fluid.

※ Caution: brake fluid will damage the painted surface, so do not let it adhere to the parts.

If attached, wash with water.



- Attach a vinyl hose to the bleeder screw and receive it with an appropriate cup on the other side of the tube. Grip the bleeder screw about 1/2 turn until the tip of the clutch lever hits the grip, tighten it again, slowly release the clutch lever, and leave it for a few seconds as it is completely returned.

※ Do not release the lever with the bleeder screw loosened.

- Repeat this until no bubbles come out from the bleeder.

※ Caution: attention to the brake fluid level in the master cylinder, fill it before lower limit line.

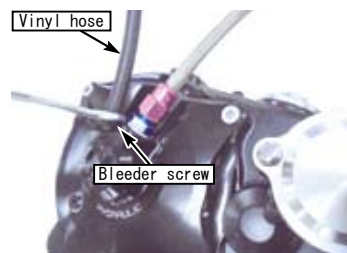

- Tighten the bleeder screw to the specified torque.

⚠ Note: Be sure that you protect specified torque.
Bleeder screw
Torque : 7.8N · m (0.8kgf · m)

- When air bleeding is completed, fill the brake fluid to the upper limit line of the reservoir and attach the diaphragm and cap.

- Secure the brake hose with a zip-tie (200 mm) to avoid interfere with other parts.

- Set color 1 and color 2 on the back side of the R. step holder.

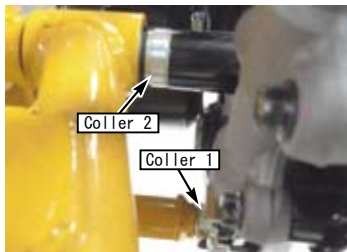

- Attach R. step holder with shim ring (12x18x0.5), U nut (M12x1.25), washer (8mm) and hex bolt (8x45).

⚠ Note: Be sure that you protect specified torque.
 U nut M12x1.25
 Torque : 54N · m (5.5kgf · m)
 Hex bolt 8x45
 Torque : 31N · m (3.1kgf · m)



After assembly

- After confirming that the drain bolt $\{T=24N \cdot m (2.4kgf \cdot m)\}$ is tightened, pour engine oil, attach the O-ring to the hole cap, apply a small amount of engine oil to the O-ring. Tighten to the specified torque.

⚠ Note: Be sure that you protect specified torque.
 Hole cap
 Torque : 11.8N · m (1.2kgf · m)

- ※ Check the amount of oil in the oil level check window frequently, and if it is below the lower limit, add the oil.

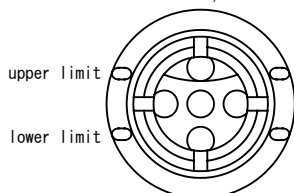

∴ Recommended oil
 SAE 10W-40 20W-50
 API classification: SG, SH, SJ, SL equivalent
 JASO standard : MA

∴ Oil capacity
 When changing oil : 900cc
 When overhauled : 1100cc

- For the engine oil viscosity, refer to the figure and use the oil with the viscosity suitable for the environment and the outside temperature.

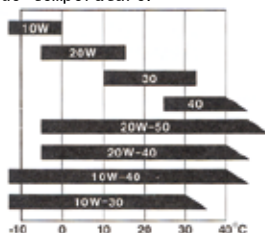

Caution

Precautions when installing an oil cooler

- When installing an optional thermostat unit

- Installing the thermostat unit.
- Remove the two oil plug bolts, attach an adapter that matches the type of hose to be used, and connect the hose.
- ※ Check the thermostat unit instruction manual.
- ※ Check the oil cooler kit instruction manual and adapter instruction manual.

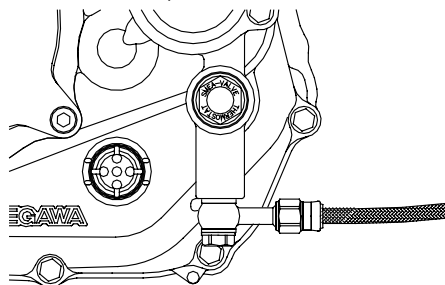

- When not installing the thermostat unit

- Remove the thermostat hole cap and insert the oil hole plug (00-02-0391) into the oil hole.
- Apply engine oil to the O-ring of the thermostat hole and tighten the hole cap to the specified torque.

⚠ Note: Be sure that you protect specified torque.
 Hole cap
 Torque : 12.7N · m (1.3kgf · m)

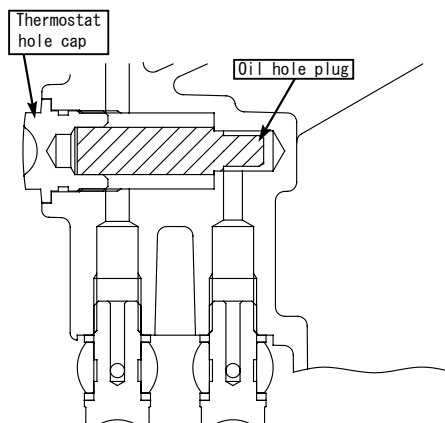

- Do not use oil hole plugs (00-02-0111).

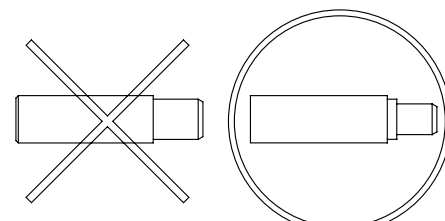

⚠ Note: If use the oil hole plug (00-02-0111), the oil passage will be closed and the engine may be damaged.

- When installing an oil hose to the oil outlet of the cylinder

⚠ Note: Never attach the thermostat unit or oil hole plug when the oil hose is not connected to the clutch cover. Oil passage will closed and engine may be damaged.

When not installing an oil cooler

- Never install a thermostat unit or oil hole plug.
 Remove a thermostat unit or oil hole plug.

⚠ Note: When the thermostat unit or oil hole plug is installed, the oil passage is closed and the engine may be damaged.

Caution: installing the oil line hose kit (00-07-0095)

- Bend the clamp to avoid lower sensor wire clamp interferes with the oil line.



Master Cylinder Instruction manual

Handle pipe diameter	Type	Piston diameter	Mirror screw diameter	Product number
22.2mm	Clutch master cylinder	12.7mm	M8 (Clockwise screw)	02-02-2103
	Clutch master cylinder (Long lever)	11mm	M10 (Clockwise screw)	02-02-2107
	Front brake master cylinder	11mm	M8 (Clockwise screw)	06-08-1169

Thank you very much for purchasing our products. Thank you so you will comply with the following matters at the time of use.
Before installation, please check your always kit contents. If there is a point of notice event, Please contact us the dealer of purchase.

◎ If the description, such as photos or illustration different with this part.

☆ Please read carefully before use ☆

- ◎ The use ignoring the instructions that are written in the manual, if the accident or damage has occurred, we can not assume any responsibility for compensation.
- ◎ This product installation and use, when a problem occurs to after market goods, guarantee other than this product, also can not assume any in any such matters.
- ◎ If it was the case or mounting that has been processed like a product, it will not be covered under warranty.
- ◎ It is not possible to inquire of the combination of other manufacturers.
- ◎ The product may have edges or protrusions. Be sure to wear work gloves when working to protect your hands.
(Please wear work gloves even if there is a photo of not wearing them in the manual.)
- ◎ It's doesn't have an oil level check window. Please check the amount of brake fluid on the upper limit line of the oil cup.
- ◎ In addition, this manual are intended for those who have a basic skills and knowledge. If no experience of mounting, etc., who preparation of such a tool is insufficient, we recommend that it is your request to the shop with a technical credit.

Caution When the handling of ignoring this display, property damage and human shows the assumption of what injury.

- When performing the work, etc., be sure during the cold (when the engine and the muffler is cold). (It may cause burns.)
- When performing the work, it should be made to prepare the tools for the job. (Breakage of parts, it may cause injury.)
- When using a blade etc, protect your hands and handle with care. (It may cause injury.)
- Do the work must always specified torque using a torque wrench. (Damage of bolts and nuts, and cause of dropout.)
- The product and the frame, might have edges or protrusions. Please go to protect your hands when you work. (It may cause injury.)
- Be sure to each part inspection before operation, check the loosening of the threaded portion, be sure to securely tighten the specified torque if there is loose. (It may cause detachment of the parts.)
- Be careful that the brake fluid does not contact your skin. After work, wash your hands thoroughly with water. Otherwise, you will have a rough skin.
- Please handle the brake fluid with great care, because the brake fluid, if spilled on painted surfaces, resin parts, or rubber products, will deteriorate or damage these parts. If the fluid is spilled on these parts, wash them immediately with water. Otherwise, the spilled portions will deteriorate or get damaged.

Warning When the handling of ignoring this display people died, shows the contents of the serious injury possibility is assumed.

- Please use only the specified brake fluid. Don not use the different brands of brake fluids together. Otherwise, the mixed use of the brake fluids will cause technical troubles or chemical reaction.
- During operation, when an abnormality occurs, immediately stop the vehicle in a safe place, please stop running. (It may lead to an accident.)
- Plastic bags of product packaging, you can either be stored in a place that is out of reach of children, it should be discarded.
(When the children or wearing, there is a risk of suffocation.)
- When performing the work, do the work safely stabilize the vehicle in a horizontal location. (There is a risk of injury vehicle collapsed while working.)
- Get the brakes installed by a skilled mechanic at facilities with special instruments and tools. (Otherwise, the wrong installation will cause accidents.)
- Inspection, maintenance, the instruction manual or, inspection methods such as service manuals, to protect the way, should be done correctly.
(unsuitable inspection and maintenance, there is a risk that result to an accident.)
- When carrying out the inspection and maintenance, etc., if found damaged parts, replace the damaged parts to avoid possible to reuse the parts.
(There is a risk that lead to accidents Continued use.)

◎ With the foreseeable incidents in mind, we have listed up these precautions for your correct use of the products and for the prevention of dangers or damages to you and other people. We do request you to take these important safety precautions against dangers.

- ◎ Please note. Performance up, the design change, the product and the price in the cost up, etc. are subject to change without notice.
- ◎ Please be informed that we shall be held harmless against any claim against us whatsoever arising out of use of the products in racing and the like.
- ◎ Keep this manual stored until this product is discarded.

Product content



Number	Product content	Quantity	Item Number
1	Master cylinder ASSY.	1	_____
2	Turn signal sub-wiring (HONDA Type-1)	1	09-03-0007 (2 pcs)

※ Photo: front brake master cylinder.
※ 2 is included with 06-08-1169.

Item parts

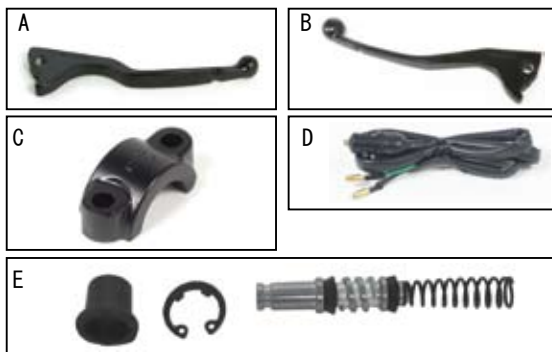

Mark	Product content	Quantity	Item Number
A	Brake lever (Black)	1	06-08-1160L
B	Clutch lever (Long/Black)	1	02-01-0127
C	Handle bracket	1	06-08-1162
D	Brake switch	1	_____
E	Piston set	1	02-02-2108

※ Please order in the repair parts are always repair part number.
If it is not the part number order, you may not be able to order.
Please be forewarned.
It should be noted, In the case of parts that can not be separately shipment, please order a set part number.
※ B is included with 02-02-2107.
※ E is only used for 02-02-2107.

SPECIAL PARTS
TAKEGAWA

CONTACT Address : 3-5-16 Nishikiorihigashi Tondabayashi Osaka JAPAN
TEL: +81-721-25-1357 FAX: +81-721-24-5059 e-mail: english@takegawa.co.jp URL http://www.takegawa.co.jp
Please contact with your name and country name provided. (Only English please)

■ Mounting procedure ※Please refer to the Genuine Service Manual for detailed mounting methods and specified torques that are not specifically described.



Mount the master cylinder assembly with the UP mark on the handle bracket facing up.
Tighten the flange bolts (upper/lower) with the specified torque.

⚠ Note: Be sure that you protect specified torque.

Flange bolt

Torque : 11.8N · m (1.2kgf · m)

Refer to the installation manual of the brake/clutch kit, attach the hose, and bleed the air.

■ Optional Parts

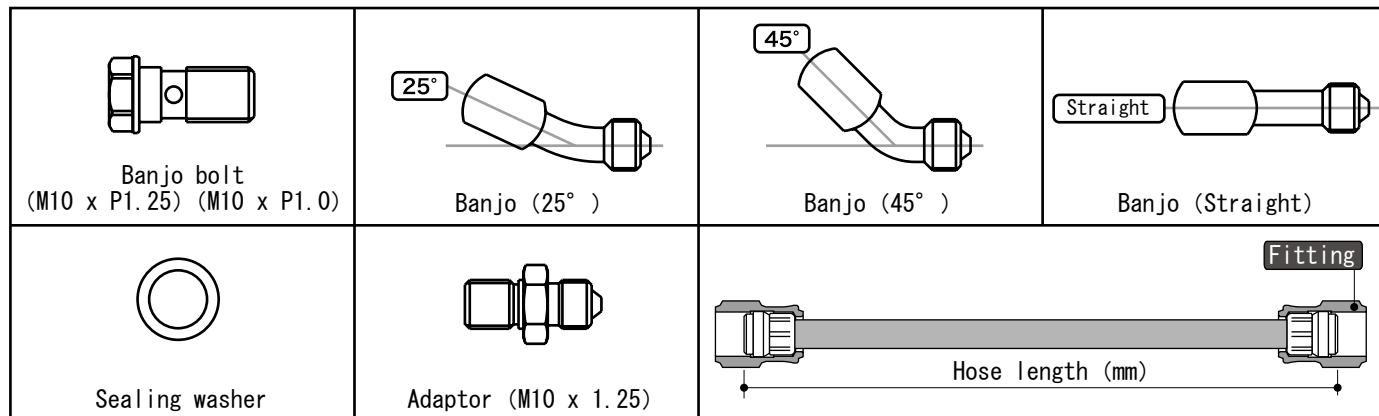

■ Banjo and banjo bolt will be sold one pieces each.

When using the master cylinder and caliper with our “slim line hose”, banjo bolts x2, banjo x2 and sealing washers x4 are required.

■ This master cylinder is compatible with M10xP1.25 banjo and adaptor.

For the brake caliper side, please check the screw size and the pitch to select the banjo and adaptor.

■ There are 3 types of banjo, straight, 25°, 45° available.

“Slim line hose” length and banjo can be selected depends on the position of the handlebar and it’s specifications.

Banjo bolt (M10 x P1.25) (Red)	00-07-0122 (Sealing washer 2 pcs)
Banjo bolt (M10 x P1.0) (Red)	00-07-0079 (Sealing washer 2 pcs)
Banjo bolt (M10 x P1.25) (Gold)	00-07-0131 (Sealing washer 2 pcs)
Banjo (25°)(Blue)	00-07-0037
Banjo (45°)(Blue)	00-07-0039
Banjo(straight) (Blue)	00-07-0006
Adaptor (Blue)	00-07-0032 (2 pcs / Sealing washer 2 pcs)
Sealing washer	00-07-0106(10 pcs)

Fitting color : Red	
Hose : Clear	
Hose length(mm)	Product number
675	00-06-0203
Fitting color : Black	
Hose : Clear	
Hose length(mm)	Product number
1160	00-06-0221

Fitting color : Gold	
Hose : Smoke	
Hose length(mm)	Product number
420	00-06-0199
500	00-06-0200
600	00-06-0201
775	00-06-0204
960	00-06-0164

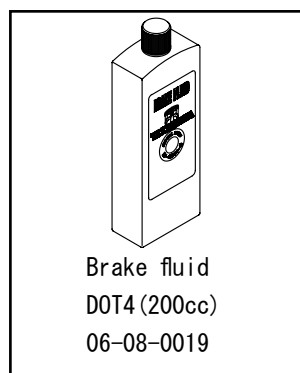

Brake fluid
DOT4 (200cc)
06-08-0019



Aluminum billet (foldable) L. lever
Clutch lever:02-01-0269
Brake lever :06-08-0243

■ It is a fold-able type lever that does not easily break when it crash.

■ The lever position can be adjusted by 6 step .

■ By replacement, the lever length will be about 30 mm longer, so lever operation will be lighter.

■ About the use of master cylinder ■

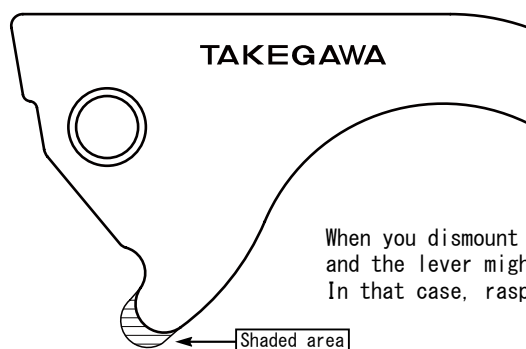

When you dismount the lever from the master cylinder, the looseness of the piston and the lever might be changed.
In that case, rasp the shaded area of the lever and adjust.