

5-Disc Upgrading SET Instruction manual

Product number 02-02-0005

Adaptation model	Monkey · Gorilla			
Requirement	Equipped with our dry clutch kit (aboung the followings)			
	02-02-120	02-03-214	02-03-429	02-03-514
	02-02-121	02-03-217	02-03-438	02-03-524
	02-02-122	02-03-418	02-03-439	02-03-534
	02-02-214	02-03-419	02-03-448	02-03-544
	02-02-215	02-03-428	02-03-449	

Thank you very much for purchasing our products.

Thank you so you will comply with the following matters at the time of use. Before installation, please check your always kit contents. If there is a point of notice event, Please contact us the dealer of purchase.

⊙ If the description, such as photos or Illustration different with this part.

☆ Please read carefully before use ☆

⊙ The use ignoring the instructions that are written in the manual, if the accident or damage has occurred, we can not assume any responsibility for compensation.

⊙ This product installation and use, when a problem occurs to after market goods, guarantee other than this product, also can not assume any in any such matters.

⊙ If it was the case or mounting that has been processed like a product, it will not be covered under warranty.

⊙ It is not possible to inquire of the combination of other manufacturers.

⊙ This product is the above-mentioned vehicle exclusive goods. Is not possible attached to the other vehicle. Please note.

⊙ Product may have edges or protrusions. Be sure to wear working gloves.

(Please wear work gloves when working, even if a photo in this article show without work gloves.)

⊙ If the friction disk gets covered with water, for example when running in the rain, clutch slipping may occur causing the clutch to be nonfunctional. If possible, avoid running in the rain, or when it is inevitable, try to skirt a puddle as much as possible to prevent the friction disc from getting wet.

⊙ If a friction disc and some other parts around it get wet, the clutch will not work. Always wipe the water off the friction disc, a clutch plate and other parts, and dry them sufficiently after riding your vehicle in the rain, or washing. In the damp climate, keep your vehicle with the clutch disengaged to prevent the friction disc, the clutch plate and other parts from sticking each other.

~ feature ~

○ We increased the number of the clutch friction discs to five, which accordingly can respond to a high-power engine.

In addition, by compounding Kevlar fiber in the clutch friction discs, we have made the discs more durable than the conventional ones.

○ The increased friction factor has brought about the decrease in the slipping, judders and noises generated when engaging the clutch.

⚠ Caution When the handling of ignoring this display, property damage and human shows the assumption of what injury.

■ When performing the work, etc., be sure during the cold (when the engine and the muffler is cold). (It may cause burns.)

■ When performing the work, it should be made to prepare the tools for the job. (Breakage of parts, it may cause injury.)

■ Do the work must always specified torque using a torque wrench. (Damage of bolts and nuts, and cause of dropout.)

■ The product and the frame, might have edges or protrusions. When working, please wear work gloves to protect your hands. (It may cause injury.)

■ Be sure to each part inspection before operation, check the loosening of the threaded portion, be sure to securely tighten the specified torque if there is loose. (It may cause detachment of the parts.)

⚠ Warning When the handling of ignoring this display people died, shows the contents of the serious injury possibility is assumed.

■ If you start the engine, be sure in a well-ventilated place. In the sealed such place, please do not start the engine. (There is a risk of carbon monoxide poisoning.)

■ Rotating parts in the dry clutch, such as a clutch outer, are touchable through an opening. Please never look into it or touch it when the engine is running. Moreover, be dressed to protect your legs when riding so you do not get your clothes caught in the rotating parts of the clutch. (Otherwise, falling accidents and human injuries may occur.)

■ If you start the engine, be sure in a well-ventilated place. In the sealed such place, please do not start the engine. (There is a risk of carbon monoxide poisoning.)

■ During operation, when an abnormality occurs, immediately stop the vehicle in a safe place, please stop running. (It may lead to an accident.)

■ When performing the work, do the work safely stabilize the vehicle in a horizontal location. (There is a risk of injury vehicle collapsed while working.)

■ Inspection, maintenance, the instruction manual or, inspection methods such as service manuals, to protect the way, should be done correctly. (unsuitable inspection and maintenance, there is a risk that result to an accident.)

■ When carrying out the inspection and maintenance, etc., if found damaged parts, replace the damaged parts to avoid possible to reuse the parts. (There is a risk that lead to accidents Continued use.)

⊙ Please note. Performance up, the design change, the product and the price in the cost up, etc. are subject to change without notice.

⊙ Please be informed that we shall be held harmless against any claim against us whatsoever arising out of use of the products in racing and the like.

⊙ Keep this manual stored until this product is discarded.

SPECIAL PARTS
TAKEGAWA

CONTACT Address : 3-5-16 Nishikiorihigashi Tondabayashi Osaka JAPAN

TEL: +81-721-25-1357 FAX: +81-721-24-5059 e-mail: english@takegawa.co.jp URL http://www.takegawa.co.jp

Please contact with your name and country name provided. (Only English please)

Product content

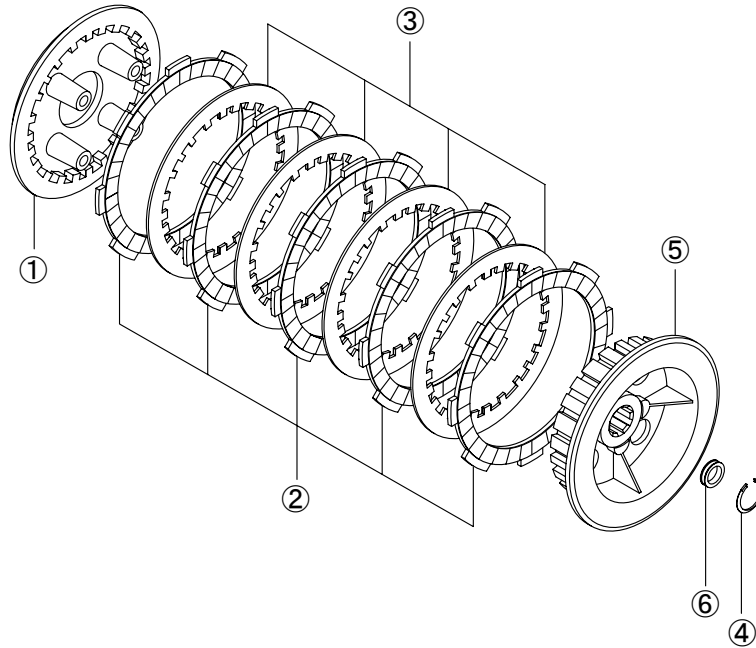

Number	Product content	Quantity	Item Number
1	Clutch pressure plate	1	00-02-0494
2	Kevlar clutch friction disc	5	00-02-0201
3	Clutch plate	4	00-02-0482
4	External circlip, 17mm	1	00-02-0005 (5 pcs)
5	Clutch center	1	00-02-6221
6	Collar	1	

- ※ Please order in the repair parts are always repair part number.
If it is not the part number order, you may not be able to order.
Please be forewarned.
- It should be noted, In the case of parts that can not be separately shipment,
please order a set part number.
- ※ Repair parts may differ slightly from the kit contents in terms of shape, etc.
There is no problem to use it. Please be forewarned.

■ Mounting procedure ※ Please refer to the Genuine Service Manual for detailed mounting methods and specified torques that are not specifically described.

Disassemble

- Remove the four bolts securing the lifter plate.
- ※ Reuse parts.
- Remove the clutch springs.
- ※ Reuse parts.
- Remove the 17mm external circlip, then remove the clutch center, friction disks, clutch plates, and pressure plate.
- ※ Replace the removed parts with new ones.

Assembly

- ※ Inspect the clutch outer, bearings, and other components for wear. Replace any parts as necessary before reassembly.
- Ensure that the bearing is seated on the clutch outer.
- Sandwich the friction discs and clutch plates alternately between the pressure plate and the clutch center, following the same sequence as shown in the component layout.
- Install the clutch assembly onto the main shaft as a single unit.
- Place the collar on the clutch center, then secure it with the 17mm external circlip.
- Install the four reused clutch springs, then tighten the lifter plate bolts in a crisscross pattern in several steps to the specified torque.
- ※ Ensure that the friction discs and clutch plates are fully seated against each other. If they are not fully seated, pull the pressure plate toward you while rotating it to align correctly.

⚠ Note: Be sure that you protect specified torque.
Bolt
Torque : 10N · m (1.0kgf · m)

© You can see this instruction manual on our website as PDF data .
If this document hard to read, please download it from our website.

