

Big throttle body kit for Super head 4V+R

Product number	03-05-0129 Super head 4V + R head mounting vehicles 03-05-0130 Genuine head mounting vehicles
----------------	--

Adaptation model and chassis numbers	GROM (JC61-1000001 ~) MSX125 (MLHJC618_D5000001 ~)
---	---

Thank you very much for purchasing our products.

Thank you so you will comply with the following matters at the time of use.

Before installation, please check your always kit contents.

If there is a point of notice event, Please contact us the dealer of purchase.

© Illustrations and descriptions such as photographs may be different from the present parts, please understand.

■ Feature

■ From genuine of the throttle body, by changing the throttle body of the bore diameter ϕ 34, you middle-high speed range is largely output increase. therefore, you can enjoy the engine characteristics around without stress to the high speed range.

● Please read carefully before use

© The use of ignoring the instructions that are written in the instruction manual, if an accident or damage has occurred, we can not assume any responsibility for compensation.

© This product installation and use, when a problem occurs to after market goods, guarantee other than this product, also can not assume any in any such matters.

© If it was the case or mounting that has been processed like a product, it will not be covered under warranty.

© It is not possible to inquire of the combination of other manufacturers.

© This product is the above-mentioned vehicle exclusive goods. Is not possible attached to the other vehicle. Please note.

© During installation, it prepares the tool or the like, do the work with care in accordance with the mounting procedure.

In addition, this manual and Honda genuine service manual are intended for those who have a basic skills and knowledge.

If no experience of mounting, etc., who preparation of such a tool is insufficient, we recommend that it is your request to the shop with a technical credit.

© Bolt, nut it is to re-use, wear, what damage is severe it without re-use, please be sure to use the new ones.

© This part is a product that was developed for the closed competition, please do not use public roads.

© This product is a kit that assumes our company made air filter kit or connecting tube, FI Con 2, muffler of the combination. Please purchase separately. FI Con 2, since different according to the model and engine, please purchase the items corresponding to use of vehicles.

! NOTE When the handling of ignoring this display, property damage and human shows the assumption of what injury.

■ When performing the work, etc., be sure during the cold (when the engine and the muffler is cold). (It may cause burns.)

■ When performing the work, it should be made to prepare the tools for the job. (Breakage of parts, it may cause injury.)

■ Do the work must always specified torque using a torque wrench. (Damage of bolts and nuts, and cause of dropout.)

■ The product and the frame, might have edges or protrusions. Please go to protect your hands when you work. (It may cause injury.)

■ Be sure to each part inspection before operation, check the loosening of the threaded portion, be sure to securely tighten the specified torque if there is loose. (It may cause detachment of the parts.)

■ Gaskets, seals, use the new parts necessarily.

As for parts to be re-used, if there is inspection worn or damaged, sure to replace it with a new part.

■ During rotation of engine, do not incorporated carelessly looking through throttle body intake pipe.

(There is that flame is injected, it is very dangerous.)

! Warning When the handling of ignoring this display people died, shows the contents of the serious injury possibility is assumed.

■ When performing the work, etc., be sure during the cold (when the engine and the muffler is cold). (It may cause burns.)

■ During operation, when an abnormality occurs, immediately stop the vehicle in a safe place, please stop running.
(It may lead to an accident.)

■ When performing the work, do the work safely stabilize the vehicle in a horizontal location.
(There is a risk of injury vehicle collapsed while working.)

■ Inspection, maintenance, the instruction manual or, inspection methods such as service manuals, to protect the way, should be done correctly. (unsuitable inspection and maintenance, there is a risk that result to an accident.)

■ When carrying out the inspection and maintenance, etc., if found damaged parts, replace the damaged parts to avoid possible to reuse the parts. (There is a risk that lead to accidents Continued use.)

■ The residence of the vaporized gasoline, do the work in well-ventilated areas because there is a risk.
(This may cause an explosion.)

■ Plastic bags of product packaging, you can either be stored in a place that is out of reach of children, it should be discarded.
(When the children or wearing, there is a risk of suffocation.)

© Please note. Performance up, the design change, the product and the price in the cost up, etc. are subject to change without notice.

© For claims, only to products that have been recognized to be defective in material and processing, to the extent within one month after purchase, we will repair or replace. However all of the cost of such exchange fees are not eligible.

Correct installation and, if it is not protected, such as how to use, it does not have this limitation.

© Until it is destroying the product, please keep this manual.

SPECIAL PARTS
TAKEGAWA

CONTACT Address: 3-5-16 Nishikiorihigashi Tondabayashi Osaka JAPAN
TEL: +81-721-25-1357 FAX: +81-721-24-5059 e-mail: english@takegawa.co.jp URL [http:// www.takegawa.co.jp](http://www.takegawa.co.jp)
Please contact with your name and country name provided. (Only English please)

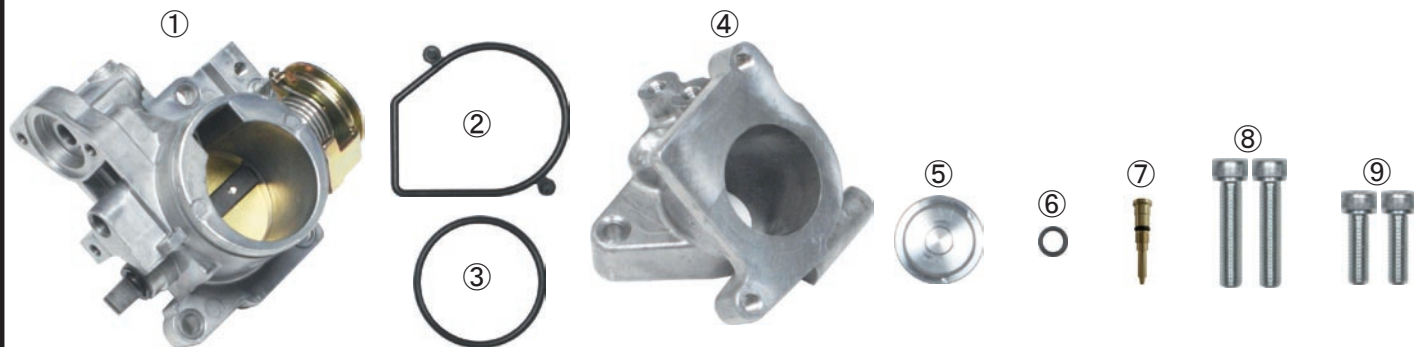

No.	Product content	Quantity	Repair Item Number
1	Big throttle body (φ 34)	1	03-05-0002
2	Rubber packing	1	00-03-0048
3	O-ring 33MM	1	00-03-0206
4	Inlet pipe	1	17111-K26-T00 (03-05-0129) 17111-K26-T10 (03-05-0130)
5	Blind plug (for MSX125)	1	91205-K26-T00
6	O-ring 6MM	1	00-00-0615 (5 pieces)
7	Idle air screw	1	00-03-0050
8	Socket cap screw 6X30	2	00-00-0090 (5 pieces)
9	Socket cap screw 6X20	2	00-00-0043 (10 pieces)

※Please note. Please order in the repair parts are always repair part number.

If it is not the part number order, you may not be able to order.

It should be noted. In the case of parts that can not be separately shipment,
please order a set part number.

■ Mounting procedure ※The mounting method and the specified torque of detail, refer to the genuine service manual.

■ First

Work in the horizontal and safe location, such as using the maintenance stand, start from to stabilize the vehicle.

⚠ Note

Exterior parts removal work in this instruction manual, we wrote only the outline that omits the details.
Inexperienced person in the exterior removal work, you can either request a work shop, be sure to work according to the manufacturer's operating procedures, tightening torque of genuine service manual instructions.
At the time also of the exterior such desorption, so as not to damage the claw and the groove, carefully and work.

Removal of the genuine parts.

Refer to the service manual, and remove the shroud, the air cleaner box, the throttle body.
Remove the intake air temperature sensor coupler in the case of GROM.

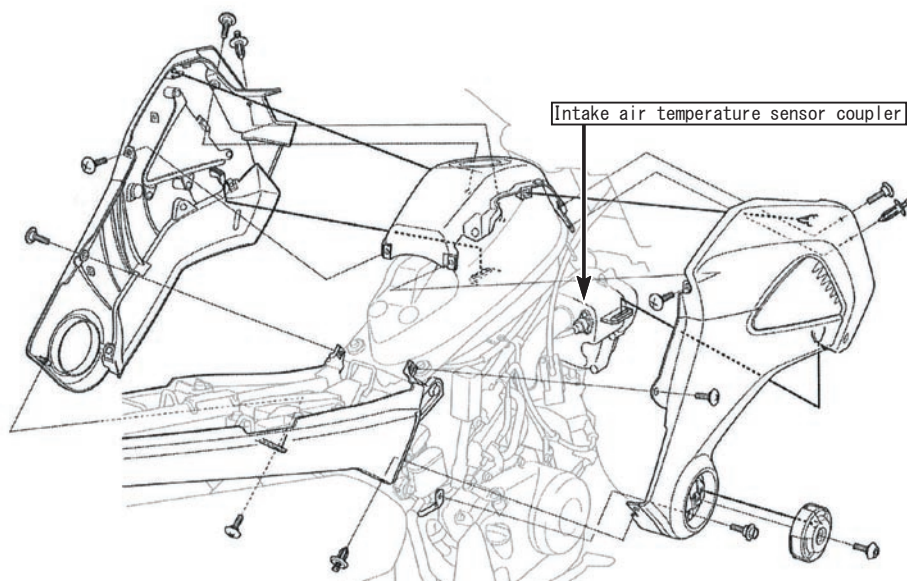

Remove the bolt and remove the throttle drum cover. Loosen the throttle cable lock nut (A). Remove the throttle cable from the cable bracket and throttle drum. Loosen connect hose band screw (B), and remove connection of the air cleaner connect hose.

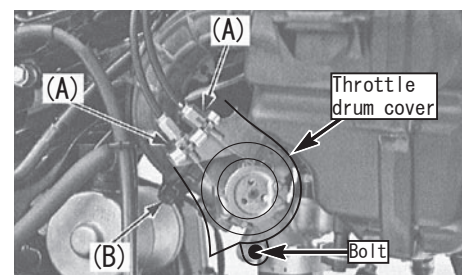

Crank breather hose (G), disconnect the fuel breather hose (H).

Loosen the connect hose band screw (I), remove the connection from the throttle body of the connect hose.

Bolt Remove (J), remove from the air cleaner case stay tab (K).

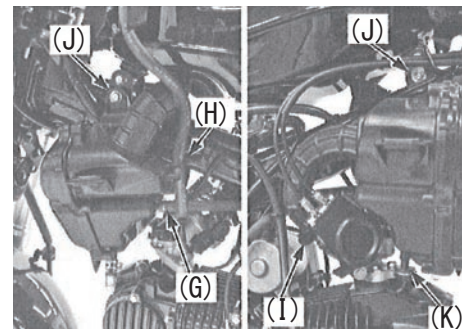

■ Mounting procedure ※The mounting method and the specified torque of detail, refer to the genuine service manual.

Throttle position sensor coupler (C), fuel injector coupler (D), it will disconnect quick connector (E).

Bolt (F), remove the throttle body.

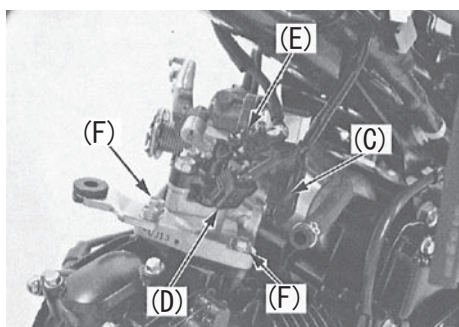

Remove the flange bolts, and remove the genuine throttle body.

Then genuine throttle body, Idle air screw (L), Spring, throttle cable bracket (M), Torx screw (N), Fast idle solenoid valve (O) ※ Not in the MSX125, Spring, the valve seat (P), O-ring, it will remove the throttle position sensor (Q).

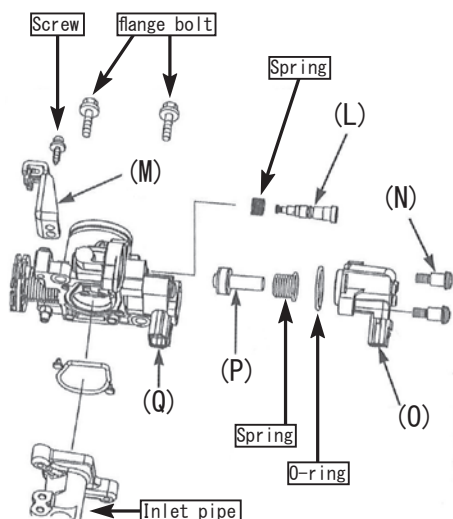

The idle air screw included in the kit, attach the spring that you removed from the genuine idle air screw to loosen 2 turns from the fully closed state.

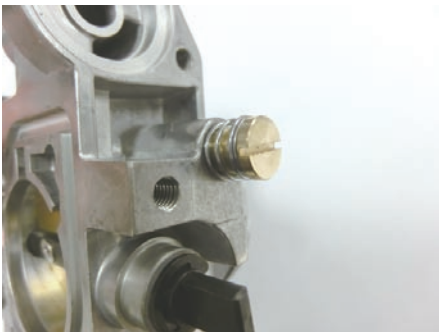

Install the removed parts to big throttle body, and tighten to the specified torque.



▲ Note

Most be carried protect the specified torque.

Idle solenoid valve TORX screw (N)

Torque : 3.4N · m (0.3kgf · m)

Throttle opening sensor TORX screw

Torque : 3.4N · m (0.3kgf · m)

Throttle cable bracket screw

Torque : 3.4N · m (0.3kgf · m)

From genuine intake pipe, remove the fuel injector joint mount bolts, fuel injector (R), seal ring, the fuel injector joint (S).

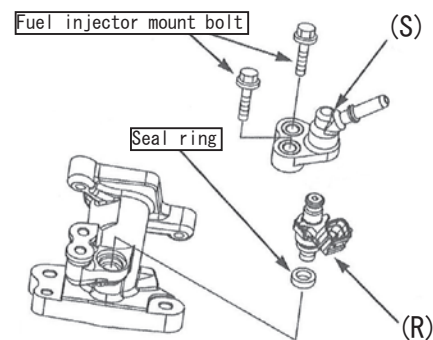

To the inlet pipe in the kit Install the O-ring.



Use socket cap screw 6 × 30, inlet pipe is attached to cylinder head, and then tighten to specified torque.

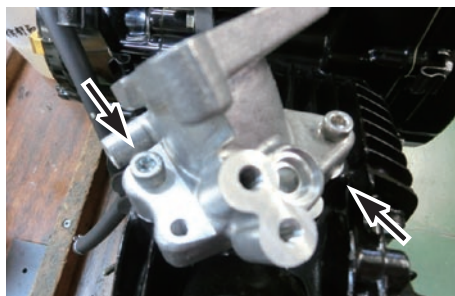

▲ Note

Most be carried protect the specified torque.

Socket cap screw

Torque : 12N · m (1.2kgf · m)

It is coated with a thin oil to the O-ring and seal ring of injector top.

Use the genuine fuel injector joint mount bolts, attach the injector fuel injector joint to the inlet pipe, and tighten to the specified torque.

▲ Warnin : Use the genuine fuel injector joint mount bolt sure.

Use of an inappropriate bolt, it becomes a cause of genuine injector joint fall off, there is a risk of serious accident.



▲ Note

Most be carried protect the specified torque.

Fuel injector joint mount bolts

Torque : 12N · m (1.2kgf · m)

Use the socket cap screw 6 × 20, Install the big throttle body to the inlet pipe, and tighten to the specified torque.

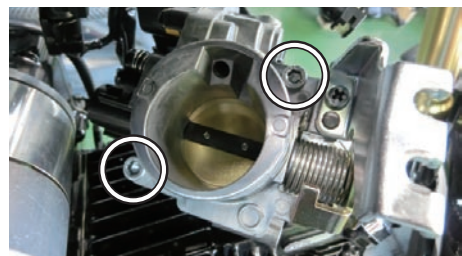

▲ Note

Most be carried protect the specified torque.

Socket cap screw

Torque : 12N · m (1.2kgf · m)

Turn the throttle pulley bottom of the bolt, an additional 1/4 rotation tightening from where you touch the throttle pulley, and tighten the nut.

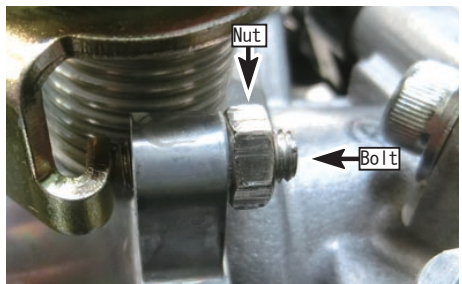

■ Mounting procedure ※ The mounting method and the specified torque of detail, refer to the genuine service manual.

Remove the main harness from the clamp of the frame.

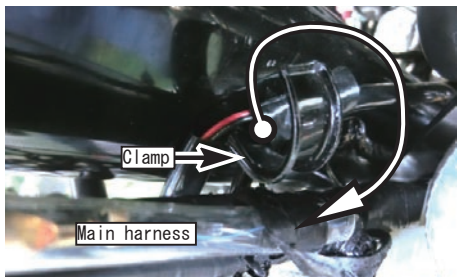

Connect the throttle position sensor coupler, fuel injector coupler, quick connector.



When used in MSX125, it requires installation of blind plug instead of the fast idle solenoid valve. Mount the O-ring 6MM to blind plug of included.



Mounting blind plug, order of the stopper plate and tightened to specified torque.



⚠ Note

Must be carried protect the specified torque.

Bolt

Torque : 3.4N · m (0.3kgf · m)

In accordance with the instruction manual, install the air filter or air cleaner box.

Measure the excess play of grip at the throttle grip flange is fitted with a throttle cable. Play:2-6mm

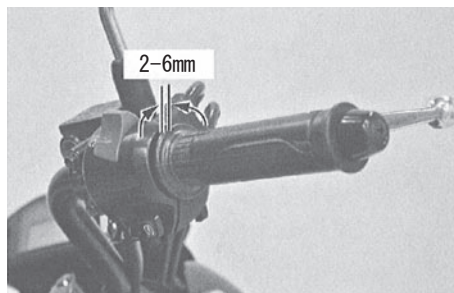

※ If you turn handlebar to left and right full, check routing of the throttle cable when rotational speed increases, need re-adjust.

Attach the throttle drum cover, and tighten to the specified torque.

⚠ Note

Must be carried protect the specified torque.

Bolt

Torque : 5.2N · m (0.5kgf · m)

When you replace the throttle body, it requires initialization of engine control unit.
Please be initialized by the following procedure.

If DTC is stored in the engine control unit, Since can not initialize the reset and the engine control unit of the throttle opening sensor, it will clear the DTC.

If the DTC is not saved, please start the work from the item of "reset of the throttle opening sensor".

※ DTC = Diagnostic Trouble Code

■ Erasure of the stored DTC

① Main switch is turned OFF and remove the sheet.

② Remove the cover from the service check coupler, thereby short-circuiting the coupler terminal by special tool.
If there is no special tool, it will not short-circuit the blue code and green /black code of red of the coupler in a suitable lead wire.

SCS Coupler: Honda genuine prts number 070PZ-ZY30100

Service check coupler

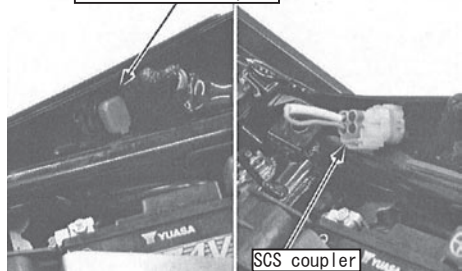

③ ON to main switch.

④ From the service check coupler, disconnect the SCS coupler or lead wire.

⑤ PGM-FI warning light and then reconnect from lit (reset receive flashing pattern) service check short coupler or lead wire to within about 5 seconds to service check coupler.

⑥ If the PGM-FI warning lamp has started blinking off (complete pattern), DTC saved it has been eliminated.

※ Always PGM - Please short circuit the service check coupler or lead wire during lighting of FI warning lamp.

If the procedure is not correct, PGM-FI warning lamp is lit after it was turned off (expired pattern).

In this case, it works again with OFF to main switch.

When the main switch to OFF before the PGM-FI warning light starts flashing, please note that the self diagnosis memory is not erased.

■ Reset of the throttle opening sensor

① Main switch is turned OFF, and remove the sheet.

② Remove the cover from the service check coupler, thereby short-circuiting the coupler terminal by special tool.

If there is no special tool, it will not short-circuit the blue code and green / black code of the coupler in a suitable lead wire.

SCS Coupler: Honda genuine prts number 070PZ-ZY30100

Service check coupler

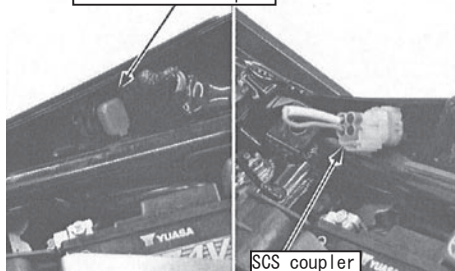

③ Remove the connection of the oil temperature sensor 2P (black) Coupler (T), and the wire-side coupler terminals shorted with a suitable leads.
Connection: yellow/blue - green/orange

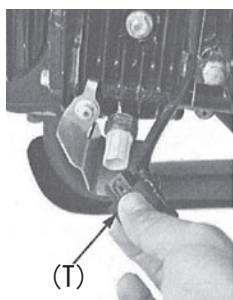

green /orange yellow /blue

④ Main switch turned ON, PGM - because FI warning light starts flashing, you can disconnect the lead wire from the oil temperature sensor 2P (black) coupler within 10 seconds. (Reset receive flashing)

⑤ Is complete if start of PGM-FI warning light flashing remove lead wire.

If the elapsed lead wire even if the 10 seconds is connected, PGM-FI warning lamp will remain lit. (reset failure pattern) Do the work again.

⑥ The main switch to OFF and connect the oil temperature sensor 2P (black) coupler, and disconnect the special tool from the service check coupler, install a dummy coupler to service check coupler.

⑦ Mounting should be done in the reverse procedure of removal.

■ Engine control unit initialization

① Main switch is turned OFF, and remove the sheet.

② Remove the cover from the service check coupler, thereby short-circuiting the coupler terminal by special tool. If there is no special tools will short the coupler with a suitable lead wire.

SCS Coupler: Honda genuine prts number 070PZ-ZY30100

③ While fully opening the throttle grip to ON the main switch.



And turns ON the main switch while keeping the state in which the full throttle



④ PGM-FI warning light is lit, begin to blink quickly. Flashing to close the throttle grip within 5 seconds to start, and keep the state for more than 3 seconds.

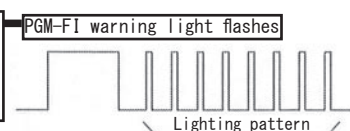

Lighting pattern is fast every 0.5 seconds flashing

Flashing to close the throttle within 5 seconds to start, and keep the state for more than 3 seconds.



⑤ When the initialization of the engine control unit is completed, PGM-FI warning lamp and repeat the flashing every 3 seconds. After completion of pattern is confirmed, set main switch to OFF.

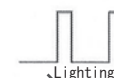

Complete lighting pattern is blinking every 3 seconds

OFF to main switch.

※ If the PGM-FI warning light does not start flashing quickly, repeat the above procedure to OFF the main switch.

※ If you do not re-start the procedure to make sure again whether the DTC to the engine control unit has not been saved.

※ If the DTC is not re-start the procedure despite not been saved, and repeat the procedure to replace a defective engine control unit.

⑥ Disconnect the special tool from the service check coupler, install a dummy coupler to service check coupler.

⑦ Refer to the instruction manual FI Con 2, make sure the engine rotation speed.

⑧ The idle air screw by turning on the basis of the standard opening rotation speed to adjust to the specified engine idling speed.