



# Instruction Manual

## Racing Down Muffler for KSR110

Item No. : 0 4 0 1 0 0 1 7  
 Fits : KSR110  
 Frame Nos : KL110A-000001 ~

- Thank you for purchasing one of our TAKEGAWA's products.
- This muffler is a racing muffler designed and developed for use in a motorcycle equipped with a TAKEGAWA-made kit.
- The stainless steel pipe and C-FRP silencer outer contribute to the weight reduction of the muffler. And the repair parts are available from us to be used as replacements for the damaged parts caused by overturning of the bike. Before using these parts, please check that they meet your engine specifications and regulations.

### Please read the following before starting the installation

This muffler is designed and produced only for use as a racing part. So, do not use this muffler for riding on the public road.  
 If other parts than those mentioned in the "Engine Specification Data" below is installed onto a bike, this muffler may fail to display its potential high performance.  
 The regulations differ from one circuit to another and from one race to another. And in some cases this muffler may not meet some of the regulations, which please note.  
 Wash the muffler with water only when the muffler is cold.  
 As this muffler is designed and produced only for use in racing, never fail to do maintenance.  
 As this muffler is only for use in racing, with the lapse of time the glass wool will deteriorate and the muffler will produce a higher level of sound. Replace the glass wool on a regular base not to violate the regulations.

**⚠ CAUTION** The following show the envisioned possibility of injuries to human bodies and property damage as a result of disregarding the following cautions.

- Always use a torque wrench to screw bolts and nuts tight to the specified torque.
- Work only when the muffler and engine are cool.

**⚠ WARNING** The following show the envisioned possibility of human death or serious injuries to human bodies as a result of disregarding the following warnings.

- Always start the engine in a well-ventilated place, and do not turn on the engine in an airtight place.
- When the engine and muffler are hot, never place hazardous materials and the flammable like gasoline near the bike.
- Before doing work, make sure your motorcycle is secure on level ground for safety's sake.
- Always replace the damaged parts with the new ones.

Please be informed that, mainly because of improvement in performance, design changes, and cost increase, the product specifications and prices are subject to change without prior notice.  
 This manual should be retained for future reference.

Engine Specification Data

Bore, stroke	56 x 50.6 (124 cc)	59 x 50.6 (138 cc)
Cylinder head	Super cylinder head+R	Super cylinder head+R
Camshaft	Racing (S-35)	Racing (S-35)
Carburetor	Keipin PE28	Keipin PE28
Transmission	4-speed close / 6-speed close transmission	4-speed close / 6-speed close transmission

## ~ Kit Contents ~

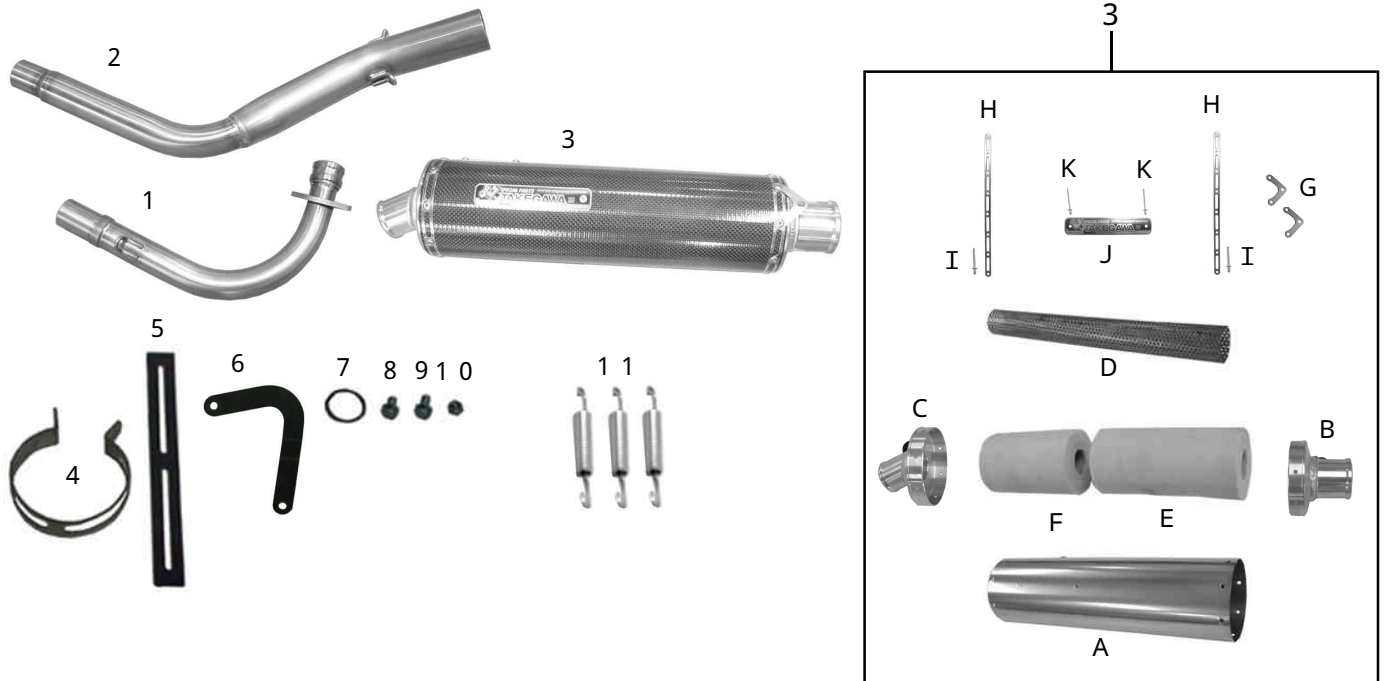

No.	Part Name	Qty	Repair Part Item No.	Qty
1	Exhaust pipe 1	1	18200-KL2-T00	1
2	Exhaust pipe 2	1	18201-KL2-T00	1
3	Silencer COMP.	1	18400-TRD-T10	1
4	Silencer band	1	91140-SDB-T00	1
5	Band rubber	1	91141-SDB-T00	1
6	Silencer stay	1	18619-KL1-T01	1
7	Exhaust pipe gasket	1	11060-1843	1
8	Flange bolt, 8 x 16	1	_____	1
9	Flange bolt, 8 x 20	1	_____	1
10	Flange nut, 8 mm	1	_____	1
11	Joint spring	3	18332-ZEP-T01	3

No.	Part Name	Qty	Repair Part Item No.	Qty
A	Outer pipe	1	18403 - TRD-T01	1
B	Cap F	1	18402 - TRD-T01-C	1
C	Cap R	1	18410 - TRD-T01	1
D	Inner pipe	1	18405 - TRD-T00	1
E	Glass wool, F	1	18404 - TRD-T10	1
F	Glass wool, R	1	18404 - TRD-T00	1
G	Spring hook	2	18330 - TRD-T00	2
H	Rivet plate	2	BW-01-0024	2
I	Blind rivet, 4 mm	16		16
J	Name plate	1	BW-01-0025	1
K	Blind rivet, 3 mm	2		2

Please order repair parts by indicating the Repair Part Item No. as listed above. As you see from the list, depending on the repair parts, we are not in a position to accept your order for a single item in the quantity of one.

## ~ Installation Instructions ~

- Attach a new exhaust pipe gasket to the engine, and install loosely for now the exhaust pipe 1 with a standard nut.
- Fit the exhaust pipe 2 into the exhaust pipe 1.
- Fix the silencer stay for the moment with an 8x16 flange bolt to a rear tap where a frame muffler was originally attached. (See a photo 1 on the right.)
- Fit the silencer COMP. into the exhaust pipe 2, and wind the band rubber around the clamp band, and put the clamp band into the silencer COMP., and with an 8x20 flange bolt and flange nut, install loosely for now the silencer band, sandwiching the silencer stay.
- Attach joint springs to the hooks on the exhaust pipe 1 and 2, and to the hooks on the exhaust pipe 2 and silencer COMP., attach the joint springs.
- Tighten a standard flange nut on the exhaust pipe 1 to the specified torque:  
**Torque: 14 ~ 16 N · m (1.4 ~ 1.6 kgf · m)**
- Tighten an 8x16 flange bolt on the silencer stay to the specified torque:  
**Torque: 23 N · m (2.3 kgf · m)**
- Tighten an 8x20 flange bolt on the silencer band to the specified torque:  
**Torque: 23 N · m (2.3 kgf · m)**
- Start the engine, and inspect the exhaust system for leaks.
- Retighten each hardware to the specified torque.



Photo 1

### SPECIAL PARTS TAKEGAWA

3-5-16 Nishikirohigashi Tondabayashi Osaka Japan  
 TEL : 81-721-25-1357 FAX : 81-721-24-5059  
 URL : <http://www.takegawa.co.jp>