



Z-Style Muffler Instruction Manual

(Product qualified by JMCA or Japan Motorcycle Accessories Association)

Item No. : 04 - 02 - 2302
Applicable to : Monkey (FI)
Frame No. : AB27-1900001 ~

Thank you for purchasing one of our TAKEGAWA's products. Please strictly follow the following instructions in installing and using the products. Before fitting the products, please be sure to check the contents of the kit. Should you have any questions about the products, please kindly contact your dealer. Before installation, please read this instruction manual carefully and understand the instructions fully. Enjoy the sound and performance of this muffler distinct from a stock muffler.

Please note that, in some cases, the illustrations and photos may vary from the actual hardware.

~ Features ~

This is a genuine-like up-muffler for the Monkey, to which a genuine muffler guard can be installed.

It improves the performance without altering the original look of the Monkey.

We have adopted a silencer body and exhaust pipe, both made of stainless, to improve the appearance and durability.

Please read the following instructions before installation.

The following show the envisioned possibility of injuries and damages to human bodies, and physical loss or damage as a result of disregarding the following cautions.

We shall be held free from any kind of warranty whatsoever of products other than this product if the glitch takes place on the other products than this one after the installation and use of this product.

This product is designed for exclusive use in the above-mentioned types of motorcycles and frame numbers only. Please take note that this product cannot be mounted on other types of motorcycles.

Please refrain from combined use of this kit with any other part than the specified parts.

Though a genuine muffler guard can be installed as it is, modification to it is necessary as the muffler guard and vehicle body may interfere with each other but depending on the slight difference in guard-mounting portion and its parts and vehicle body.

This product is designed for exclusive use in a stock kick starter arm. (In case of TAKEGAWA's kick starter, the arm will interfere with the genuine muffler guard.)

This product cannot be used together with a (wire-type) Dry-Type Clutch Kit of 02-02-0143. For the installation of the said Kit, the installation of a Hydraulic Clutch Kit of 02-02-0144 is necessary.

CAUTION

The following show the envisioned possibility of injuries and damages to human bodies, and property loss as a result of disregarding the following cautions.

- Always try to drive your motorcycle at a legal speed, abiding by the laws.
- Work only when the engine and the muffler are cool. (Otherwise, you will burn yourself.)
- Prepare right tools for the work, and do the work in the proper and right way.
(Otherwise, improper work could cause breakage of parts or injuries to yourself.)
- Always use a torque wrench to screw bolts and nuts tight and securely to the specified torque.
(Improper torque could cause these parts to get damaged or fall off.)
- As some products and frames have sharp-pointed or protruding portions, please work with your hands protected.
(Otherwise, you will suffer injuries.)
- Do water washing of a muffler only when it is cool. (Otherwise, the muffler may be cracked.)
- Park your motorcycle in a place where pedestrians will not touch the muffler accidentally. Besides, please always be considerate enough not to park it in the way of pedestrians or moving vehicles.
(If you park your motorcycle on the sidewalk with its muffler on the pedestrians' side, the pedestrians may touch the muffler and get burned or suffer property loss.)
- Before riding, always check every section for slack in parts like screws. If you find slack ones, screw them securely up to the specified torque.
(Or improper torque may cause parts to come off.)
- This muffler is designed for exclusive use in a stock kick starter arm. TAKEGAWA's kick starter arm will interfere with the genuine muffler guard.

**WARNING**

The following show the envisioned possibility of human death or serious injuries to human bodies as a result of disregarding the following cautions.

- Always drive the engine in a well-ventilated place, and do not switch the engine on in an airtight place.
(Otherwise, you will suffer from carbon monoxide poisoning.)
- Never look into the muffler outlet when the engine is revolving. (Otherwise, you will suffer from carbon monoxide poisoning or lose your sight.)
- When you notice something abnormal with your motorcycle while riding down a road, stop riding immediately and park your motorcycle in a safe place. (Otherwise, the abnormality could lead to an accident.)
- Before riding, be sure to always check the bank angle, and run with care not to bank the vehicle more steeply than the bank angle.
(Otherwise, there will be a danger of the motorcycle overturning.)
- The engine and the muffler are at high temperatures when the engine is revolving or for some time after the engine stopped. Therefore, never place flammable or hazardous materials such as gasoline near them. (Otherwise, there will be a danger of causing fires.)
- Before doing work, place the motorcycle on level ground to stabilize the position of your motorcycle for safety's sake.
(Otherwise, your motorcycle could overturn and injure you while you are working.)
- Check or perform maintenance of parts correctly according to the procedures in the instruction manual or a service manual.
(Improper checking or maintenance could lead to an accident.)
- If you find damaged parts when checking and performing maintenance, do not use these parts any longer, and replace them with new ones.
(The continued use of these damaged parts as they are could lead to an accident.)
- Keep plastic bags for packing products out of children's reach, or discard them.
(If children get them on, there will be a danger of their suffocating.)
- Basically, you can install this muffler in almost the same way as installing a stock muffler. Although a genuine muffler can be fixed, a guard for an exhaust pipe (right behind the engine exhaust) cannot be installed. So, please do be careful not to let your right leg touch the exhaust pipe when pressing down on the rear brake pedal.
Besides, do not ride the vehicle in an exposed style, such as in sandals. (It could lead to burn or accidents.)

Please be informed that, mainly because of improvement in performance, design changes, and cost increase, the product specifications and prices are subject to change without prior notice.

You are kindly requested not to contact us about the combination of our products with other manufacturers'.

This manual should be retained for future reference.

~ Kit Contents ~

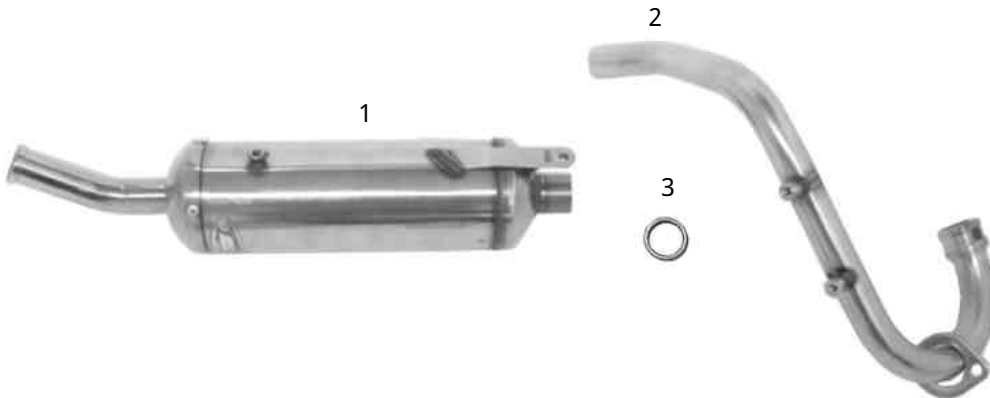

No.	Parts Name	Qty	Repair Part Item No.	In packs of
1	Silencer assembly	1	_____	_____
2	Exhaust pipe	1	118200-FM1-T00	1
3	Exhaust gasket	1	00-01-0064	2

Please note that in ordering repair parts, be sure to quote the Repair Part Item No. Otherwise, we may not be able to accept your orders.

There are some parts, however, for which we are not in a position to accept your order in just the quantity to be used. In this case, please take them in the quantity packed.

~ Installation Procedures ~

Stabilize the vehicle with a maintenance stand or the like in a safe and level place during work.

Genuine Muffler Removal

1. Unfasten two nuts on the exhaust pipe flange. Keep them for re-use.
If the nuts are worn or damaged severely, replace them with new ones.

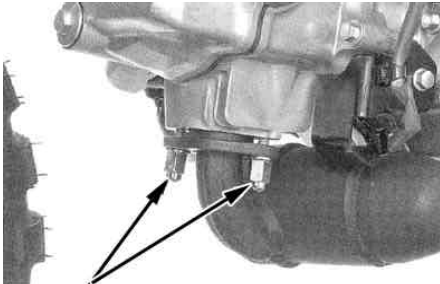

Joint nut

2. Unfasten the hex' bolt which is fixing the muffler.

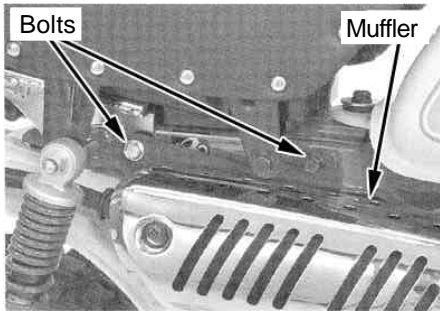

Bolts

Muffler

3. Demount the muffler from the vehicle body.

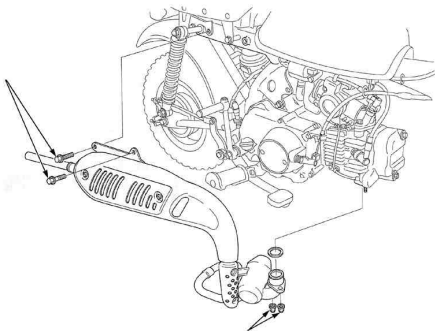

4. Remove the old exhaust pipe gasket remaining in the exhaust port.

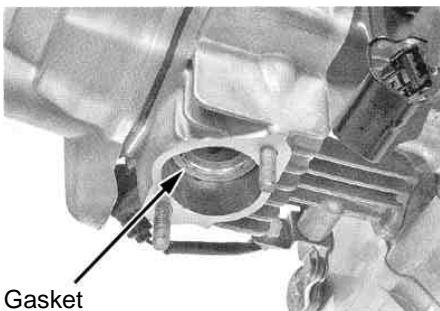

Gasket

Genuine Muffler Guard Removal

1. Detach the muffler guard from the just-removed genuine muffler.
2. Unscrew all plus screws which are fixing the muffler guard to the muffler. Keep those screws for re-use.
If the screws are worn or damaged severely, replace them with new ones.

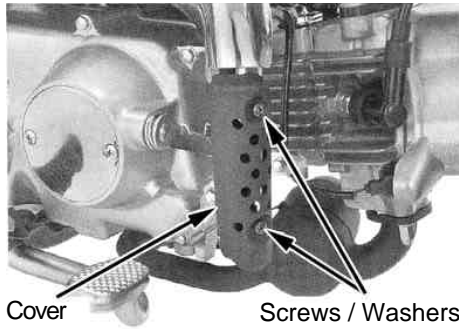

Cover

Screws / Washers

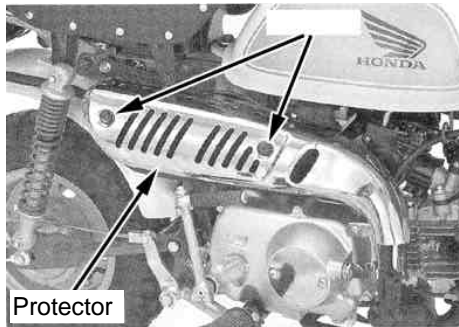

Protector

⚠ CAUTION: Plus screws may be very tightly screwed, so unscrew them with enough care not to damage their heads.

3. Though the genuine muffler guard can be installed as it is, the stay, which is holding the guard at the genuine exhaust pipe, gets exposed if the muffler guard is not modified. Therefore, cut off the unnecessary part on the muffler guard as shown in the photo below.



Cut off this part

• If the exposing portion is cut off, it is advisable to give a touch-up to the cut surface with a heat-resistant paint to prevent the surface from rusting.

Z-Style Muffler Installation

1. Insert and install a kit's exhaust pipe gasket to the exhaust port.

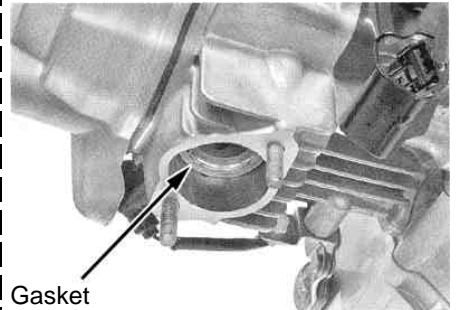

Gasket

2. Loosely install for now the silencer assembly to the frame. Pass the rear end of the silencer pipe behind the upper part of the right-side rear shock absorber. And mount it on the frame with a standard bolt.



3. After inserting the exhaust pipe into the joint on the silencer assembly, insert its flange into the engine.

It is advisable to apply heat-resistant liquid gasket to the inserting portion.
(ThreeBond 1207B or the equivalent.)



Apply the liquid gasket here.

- 4 . Pass the exhaust pipe flange through the stud bolt of the cylinder head, and fix it temporarily with the nuts which were used to fix the genuine muffler.

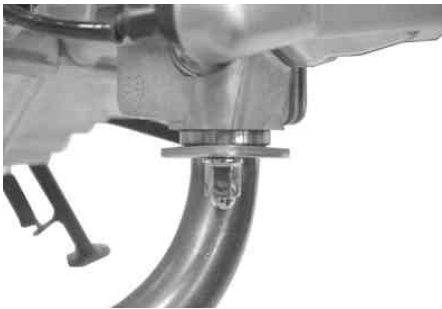

- 5 . Check the clearance between the silencer's exhaust pipe and the rear fender, and then adjust the positions of the silencer and the exhaust pipe so that they do not interfere with each other.



- 6 . Tighten the exhaust pipe flange nuts evenly to the specified torque with care not to let the silencer and the exhaust pipe get out of the adjusted places.

Torque : 12 N · m (1.2 kgf · m)

⚠Caution: Never fail to observe the specified torque.



- 7 . Then, tighten the standard bolt on the silencer stay to the specified torque.

Torque : 29 N · m (3.0 kgf · m)

⚠Caution: Never fail to observe the specified torque.



- 8 . Install the genuine muffler guard. As the screw is apt to come off from the vibrations of the vehicle, it is advisable to apply screw-locking agent to it like a Lock Tight 241, or the equivalent.



- 9 . Install an exhaust pipe cover onto the exhaust pipe in the reverse order of removal. As this screw is apt to come off from the vibrations of the vehicle, it is advisable to apply screw-locking agent to it like a Lock Tight 241, or the equivalent.



- 10 . Check for interference among the genuine muffler guard, the muffler, and the frame. If need be, loosen the screws and nuts on each section to adjust the position of the muffler and install it securely but to the extent that too much strain is not placed on the muffler. Moreover, when the muffler guard, seat stay and silencer interfere with each other, modify or deform the interfering portions to maintain the proper clearance.



- 11 . If a standard kickstarter arm interferes with the muffler guard, change the location of the serration until the kickstarter arm does not interfere with the muffler guard any longer, and install the kickstarter arm.

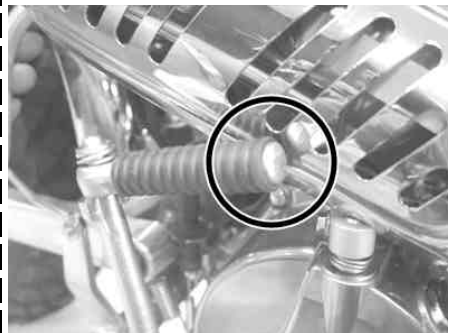

- 12 . Peel a protective film off a JMCA plate.

Final Checking

- 1 . Start the engine in a safe and well-ventilated place, and check for exhaust leak or interference.
- 2 . After stopping the engine and after each part has cooled down to the normal temperatures, re-tighten all screws and nuts to the specified torque.

The misc.:

If you have installed our special clutch cover, the muffler guard and clutch release arm will interfere with each other. Before installing the muffler guard, modify the interfering portions. If you have cut off the interfering portions, it is advisable to give touch-up to the cutting surface with the heat-resistant paint to prevent the cut surface from rusting.



SPECIAL PARTS TAKEGAWA Co.,Ltd.

3-5-16 Nishikiorihigashi Tondabayashi
Osaka Japan

TEL : 81-721-25-1357 FAX : 81-721-24-5059

URL : <http://www.takegawa.co.jp>