



Instruction Manual for Bomber L2 Muffler for XR50 / 100 Motard

Item No. : 0 4 - 0 2 - 2 7 3 1

Application

HONDA-made

XR50 Motard : AD14-1000001 ~

XR100 Motard : HD13-1000001 ~

- Thank you for purchasing one of our TAKEGAWA's products. Please strictly follow the following instructions in installing and using the products.
- Before installing the products, please be sure to check the product contents. Should you have any questions about the products, please contact your local motorcycle dealer.
- We strongly hope that you will use the kit with the full knowledge of this Instruction Manual.
- Enjoy the sound and performance of this muffler distinct from a stock muffler.

~ Features ~

The exhaust pipe, being made of stainless and buff-finished, has the improved appearance and durability.

The tandem step on XR100 Motard can be installed without any processing.

Read all instructions first before starting the installation.

We do not take any responsibility for any accident or damage whatsoever arising from the use of the kit not in conformity with the instructions in the manual.

We shall be held free from any responsibility or compensation whatsoever for any glitch in the parts other than ours if the glitch takes place after the installation and use of the products.

If you make modifications to any of the provided products, we shall be held free from any guarantee of the product.

You are requested not to contact us about the combination of our products with other manufacturers'.

Please note that this product is designed for exclusive use in the above-mentioned compatible models and that it cannot be mounted on any other models.

Please order repair parts referring to Item Nos and reference Nos described in this manual. Should you have any questions about the products, please kindly contact your local motorcycle dealer.

In case this muffler is installed onto XR100 Motard, basically the tandem driving is impossible because a right tandem step and exhaust pipe is close to each other, although the tandem step can be installed without any processing. In case you are forced to do tandem driving for some reasons, be careful about the damage to shoe soles or burns.



CAUTION

The following show the envisioned possibility of injuries to human bodies and property damage as a result of disregarding the following cautions.

- Always try to drive your motorcycle at legal speed, abiding by the laws.
- Work only when the engine and muffler are cool. (Otherwise, you will get burned.)
- Do the installation with right tools. (Otherwise, breakage of parts or injuries to you may take place.)
- Always use a torque wrench to screw bolts and nuts tight and securely to the specified torque. (Otherwise, these parts may get damaged or fall off, resulting in accidents.)
- As some products and frames have sharp edges or protruding portions, please work with your hands protected. (Otherwise, you will suffer injuries.)
- Wash the muffler with water only when the muffler is cold. (Otherwise, the muffler will get cracked.)
- Park your motorcycle in a place where pedestrians will not touch the muffler accidentally. Besides, please always be considerate enough not to park it in the way of pedestrians or moving vehicles. (If you park your motorcycle on the sidewalk with its muffler on the pedestrian side, the pedestrians may touch the muffler and get burned or suffer property damage.)
- Before riding, always check every hardware like screws for slack. If you find slack ones, screw them securely up to the specified torque. (Otherwise, improper tightening may cause parts to come off.)



WARNING

The following show the envisioned possibility of human death or serious injuries to human bodies as a result of disregarding the following warnings.

- Work only when the engine and muffler are cool. (Otherwise, you will get burned.)
- Do the installation with right tools. (Otherwise, breakage of parts or injuries to you may take place.)
- Never look into the outlet on the muffler when the engine is running. Otherwise, you will suffer from carbon monoxide poisoning and loss of sight.
- When you notice something abnormal with your motorcycle while riding, immediately stop riding and park your motorcycle in a safe place. (Otherwise, the abnormality could lead to accidents.)
- The engine and the muffler are at high temperatures when the engine is revolving or for some time after the engine stopped. Therefore, never place flammable or hazardous materials such as gasoline near the bike. (Otherwise, there will be dangers of fires.)
- Before doing work, place the motorcycle on level ground to secure it for safety's sake. (Otherwise, your motorcycle could overturn and injure you while you are working.)
- Check or carry out maintenance of your motorcycle correctly according to the procedures in the instruction manual or service manual. (Improper checking or maintenance could lead to accidents.)
- If you find damaged parts when checking and performing maintenance of your motorcycle, do not use these parts any longer, and replace them with new ones. (The continued use of these damaged parts as they are could lead to accidents.)
- Keep plastic bags for packing the products out of children's reach, or discard them. (If children get them on, there will be a danger of their suffocating.)
- In case this muffler is installed onto XR100 Motard, basically the tandem driving is impossible because a right tandem step and exhaust pipe is close to each other, although the tandem step can be installed without any processing. In case you are forced to do tandem driving for some reasons, be careful about the damage to shoe soles or burns.

Please be informed that, mainly because of improvement in performance, design changes, and cost increase, the product specifications and prices are subject to change without prior notice.

You are requested not to contact us about the combination of our products with other manufacturers'.

This manual should be retained for future reference.

Kit includes:

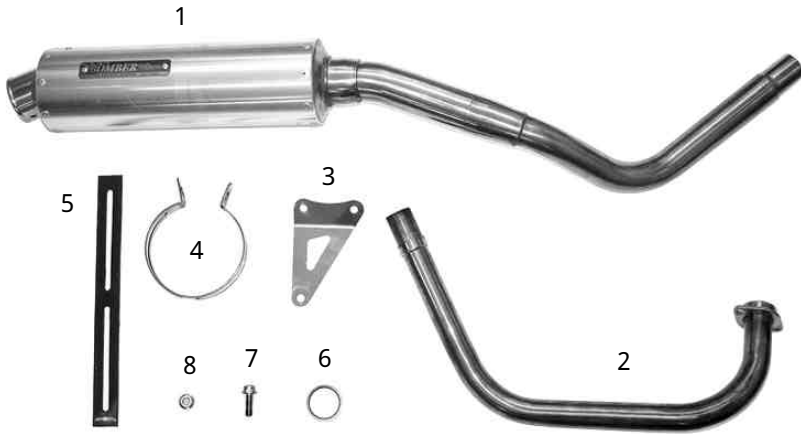

No.	Part Name	Qty
1	Silencer assembly	1
2	Exhaust pipe COMP.	1
3	Silencer stay	1
4	Clamp band	1
5	Band rubber	1
6	Exhaust gasket	1
7	Flange bolt, 8 x 20	1
8	Flange nut, M8	1

~ Installation Instructions ~

Removal of genuine muffler

- 1 . Make sure that your bike is secure on a maintenance stand.



⚠ Warning : Stand your bike in a safe, secure place

- 2 . Remove a flange bolt on the right-side cover to remove the right-side cover.



- 3 . Remove two nuts on the exhaust pipe.



- 4 . Remove two flange bolts securing the muffler. Keep these flange bolts, which you will be re-using. And in case they are severely damaged, replace them with new ones.



- 5 . Detach a muffler from the vehicle.

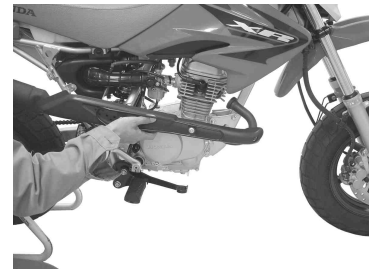

- 6 . Detach a used exhaust gasket in the exhaust port.



Installation of Bomber L2 Muffler:

- 1 . Fit the provided exhaust pipe gasket into the exhaust port and install it.



- 2 . Fit the exhaust pipe COMP. into the cylinder exhaust side, and tighten it loosely for now with a genuine nut.

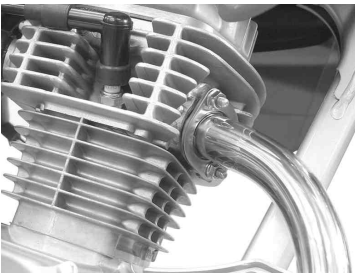

- 3 . Secure the silencer stay to the genuine muffler stay on the bike with a genuine muffler bolt.

Tightening torque:

22 N·m (2.2 kgf·m)



- 4 . Fit the silencer assembly into the exhaust pipe COMP.
It is advisable to apply heat-resistant liquid gasket (ThreeBond 1207B or the equivalent) to the inserting portion.

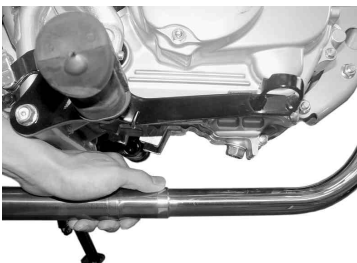

- 5 . Attach the band rubber to the inside of the clamp band, and fit the clamp band to the silencer. And secure it to the silencer stay for now with an 8x20 flange bolt and M8 flange nut.

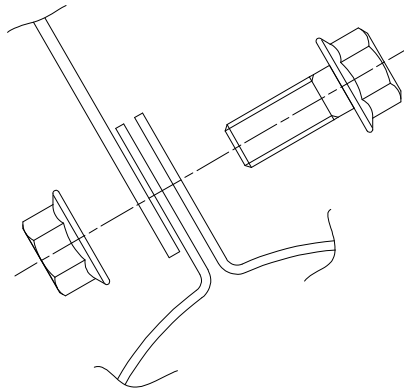

- 6 . First, adjust the positions of silencer and exhaust pipe. Then, being careful not to let these parts get out of place, tighten up the flange nut on the cylinder- head exhaust port equally to the specified torque.

Tightening torque:

10 ~ 12 N·m (1.0 ~ 1.2 kgf·m)

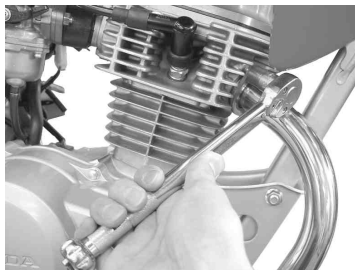

- 7 . Firmly fasten the clamp band securing the silencer.

Tightening torque:

22 N·m (2.2 kgf·m)



- 8 . After securing the silencer, make sure that the muffler and silencer do not interfere with the tandem steps or the bike.

- 9 . Install back the right-side cover in its original location.

- 10 . Wipe off the dirt stuck on the muffler, and remove a protective film on a BOMBER emblem.

Final confirmation:

- 1 . Start the engine in a well-ventilated place, and check every hardware for exhaust air leak and interference.
- 2 . After stopping the engine and after each hardware has cooled down to the stock temperatures, re-tighten all screws and nuts to the specified torque.

SPECIAL PARTS TAKEGAWA

3-5-16 Nishikiorihigashi Tondabayashi

Osaka Japan

TEL : 81-721-25-1357

FAX : 81-721-24-5059

URL : <http://www.takegawa.co.jp>