

Rear shock absorber Instruction manual

Product number 06-04-0062

Adaptation model	GROM (JC61-1000001 ~ 1299999)
	(JC61-1300001 ~)
	(JC75-1000001 ~)
	(JC92-1000001 ~)
	MSX125
	MSX125SF
	MSX GROM (MLHJC92)

Thank you very much for purchasing our products.

Thank you so you will comply with the following matters at the time of use. Before installation, please check your always kit contents. If there is a point of notice event, Please contact us the dealer of purchase.

◎ If the description, such as photos or Illustration different with this part.

☆ Please read carefully before use ☆

- ◎ The use ignoring the instructions that are written in the manual, if the accident or damage has occurred, we can not assume any responsibility for compensation.
- ◎ This product installation and use, when a problem occurs to after market goods, guarantee other than this product, also can not assume any in any such matters.
- ◎ If it was the case or mounting that has been processed like a product, it will not be covered under warranty.
- ◎ It is not possible to inquire of the combination of other manufacturers.
- ◎ This product is the above-mentioned vehicle exclusive goods. Is not possible attached to the other vehicle. Please note.
- ◎ For GROM (JC92-1000001 ~) and MSX GROM (MLHJC92) ,must use the silencer joint sealing.

~ feature ~

- It is a rear shock absorber reviewing damping and spring rate of original rear shock.
- It is possible to adjust the spring in hardness with an emphasis on 2-seater from 1 seater. (Stepless adjustment)

⚠ Caution When the handling of ignoring this display, property damage and human shows the assumption of what injury.

- When performing the work, etc., be sure during the cold (when the engine and the muffler is cold). (It may cause burns.)
- When performing the work, it should be made to prepare the tools for the job. (Breakage of parts, it may cause injury.)
- Do the work must always specified torque using a torque wrench. (Damage of bolts and nuts, and cause of dropout.)
- The product and the frame, might have edges or protrusions. Please go to protect your hands when you work. (It may cause injury.)
- Be sure to each part inspection before operation, check the loosening of the threaded portion, be sure to securely tighten the specified torque if there is loose. (It may cause detachment of the parts.)

⚠ Warning When the handling of ignoring this display people died, shows the contents of the serious injury possibility is assumed.

- The technology and those who no knowledge, please do not to work. (The cause of parts damage etc., could result in falls and accidents.)
- During operation, when an abnormality occurs, immediately stop the vehicle in a safe place, please stop running. (It may lead to an accident.)
- When performing the work, do the work safely stabilize the vehicle in a horizontal location. (There is a risk of injury vehicle collapsed while working.)
- Inspection, maintenance, the instruction manual or, inspection methods such as service manuals, to protect the way, should be done correctly. (unsuitable inspection and maintenance, there is a risk that result to an accident.)
- When carrying out the inspection and maintenance, etc., if found damaged parts, replace the damaged parts to avoid possible to reuse the parts. (There is a risk that lead to accidents Continued use.)

- ◎ Please note. Performance up, the design change, the product and the price in the cost up, etc. are subject to change without notice.
- ◎ Please be informed that we shall be held harmless against any claim against us whatsoever arising out of use of the products in racing and the like.
- ◎ Keep this manual stored until this product is discarded.

Product content



No.	Product content	Qty
1	Rear shock absorber COMP.	1
2	Adjusting wrench	2

SPECIAL PARTS
TAKEGAWA

CONTACT Address : 3-5-16 Nishikiorihigashi Tondabayashi Osaka JAPAN
TEL: +81-721-25-1357 FAX: +81-721-24-5059 e-mail: english@takegawa.co.jp URL http:// www.takegawa.co.jp
Please contact with your name and country name provided. (Only English please)

For GROM (JC61-1000001 ~ 1299999), MSX125

- Please use a maintenance stand to stabilize the vehicle.
- Sheet, right shroud, drive chain cover, rear brake reservoir (frame side), remove the regulate rectifier and regulator bracket, and remove the upper mount nut and lower mount nut.
- ※ If it is difficult to remove the upper mount nut, there is a possibility that work becomes easier and remove a left shroud.

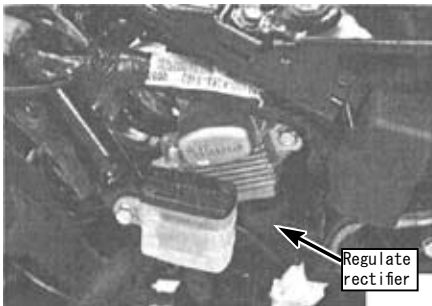
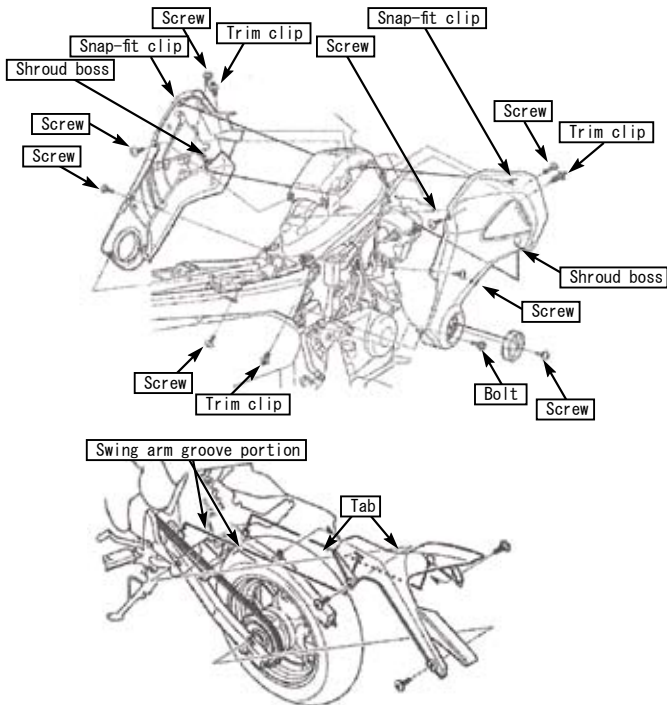

(The photo shown for GROM)

For GROM (JC61-1300001 ~ /JC75-1000001 ~), MSX125SF

- Please use a maintenance stand to stabilize the vehicle.
- Remove: seat, body cover / tail cover, R. shroud cover, L. shroud cover, drive chain cover, seat lock keycylinder then remove the upper mount nut and lower mount nut.
- Use a stand jack etc. to remove the load from the rear shock absorber and uninstall it.
- Install the rear shock absorber.

For GROM (JC92-1000001 ~), MSX GROM (MLHJC92)

- Please use a maintenance stand to stabilize the vehicle.
- Remove the seat.
- Remove the three screws M5x14 at the R side cover.



- Remove the flange bolts of rear brake reservoir and remove the relay behind the reservoir tank from the frame.



- Loosen the band of the silencer pipe joint (that secures the exhaust pipe and silencer), remove the mount bolt / flange nut (that secures the silencer), and remove the silencer.



■ Mounting procedure ※ Mounting methods and specified torque of detail, refer to genuine service manual.

○ Remove the three screws M6x12 of the drive chain cover.

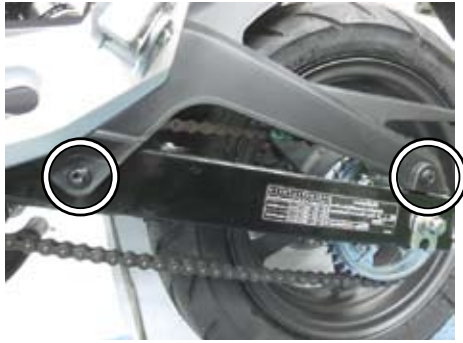

For GROM(JC92-1000001 ~)

○ Turn off the ignition key and remove the gyro sensor.



For MSX GROM(MLHJC92)

○ Remove the two screws M5x12 of battery front cover.



○ Remove the upper mount nut and lower mount nut.

※ Remove the upper mount nut. Caution: Be careful for the positive terminal of the battery is near.

○ Use a jack stand etc. to remove the load from the rear shock and remove the shock unit.

○ Install the rear shock absorber.

○ Tighten the upper mount nut and lower mount nut to the specified torque.

⚠ Note: Be sure to protect specified torque.

Upper Mount nut	: 44N · m(4.4kgf · m)
Lower mount nut	: 44N · m(4.4kgf · m)

○ After installation is complete, attaches in the reverse procedure of removing other parts.

For GROM(JC61-1000001 ~ 1299999), MSX125

⚠ Note: Be sure to protect specified torque.

Screw 6X12 (drive chain cover)	: 9N · m(0.9kgf · m)
Screw 5X14 (shroud cover)	: 10N · m(1.0kgf · m)
Bolt 6mm (each mounting bolt)	: 10N · m(1.0kgf · m)
Shroud screw	: 4.2N · m(0.4kgf · m)

For GROM(JC61-1300001 ~ /JC75-1000001 ~), MSX125SF

⚠ Note: Be sure to protect specified torque.

Bolt 6mm(shroud cover, drive chain cover)	: 10N · m(1.0kgf · m)
Bolt 5mm	: 5.2N · m(0.5kgf · m)
Flange bolt 6mm (each mounting bolt)	: 10N · m(1.0kgf · m)
Screw 5mm	: 4.2N · m(0.4kgf · m)
Screw 4mm	: 0.9N · m(0.1kgf · m)

For GROM(JC92-1000001 ~), MSX GROM(MLHJC92)

⚠ Note: Be sure to protect specified torque.

Screw 5x12 (cover)	: 4.2N · m(0.4kgf · m)
Screw 6X12 (drive chain cover)	: 9N · m(0.9kgf · m)
Exhaust silencer mount	: 27N · m(2.8kgf · m)
Exhaust muffler band	: 20N · m(2.0kgf · m)
Flange bolt 6mm	: 10N · m(1.0kgf · m)
Screw 5x14 (R. Side cover)	: 4.2N · m(0.4kgf · m)

⚠ Note: Be sure to adjust the spring preload while it is attached on the vehicle.
It may cause malfunction or damage.