



Item No. : 0 9 0 1 0 2 1 1
Applicable to : Magna50
Frame No. : AC13-1000010 ~

- Thank you for purchasing one of our products. Please strictly follow the instructions to install and use the products.
- Before installing the products, please be sure to check the contents of the kit. If you have any questions about the products, please kindly contact your local TAKEGAWA dealer.

Please note: Illustrations and photos may vary from actual hardware.

Please read the following instructions before installation

We do not take any responsibility for any accident or damage whatsoever arising from the use of the products not in conformity with the instructions in the manual.

We shall be held free from any responsibility or compensation whatsoever for any glitch in parts other than ours if the glitch takes place after installation and use of this product.

If you make alterations to the product, we shall be held free from any guarantee of the product.

You are kindly requested not to contact us about the combination of our products with other manufacturers'.

Please use this LCD meter with the following precautions in your mind:

- A Liquid crystal display on the meter has characteristics that it tends to turn dark when exposed to the sunlight for long hours. Please take care not to leave it subjected to the direct sunlight. If it should become dark, keep it away from the direct sunlight and cool it, and the display will return to its original brightness before long. But it is likely that spots may remain on the display as aftereffects particularly when the display is left exposed to the strong direct sunlight for a long time in midsummer, which please take note.
- This product is not perfectly waterproofed. The use in a highly humid atmosphere will likely result in display's getting blurred because the meter gets wet inside.
- Depending on the conditions of a battery, plug, and connections of wires, there is a possibility of malfunctions like an incorrect display of readings on the meter. The power supply for a meter installed on a vehicle with a battery in poor condition or installed on a battery-less vehicle is not stable. For this reason, there is a case where the wrong readings will appear at the time of engine-starting, though only for a moment, but this is not a malfunction or a failure. On a vehicle whose meter power source fluctuates wildly, or on an ignition-system vehicle with high ignition noise, the meter may show wrong readings like distance and revolution because of disturbance in electrical signals in the meter.
- When installing this kit, check every section thoroughly, especially wiring, ignition system, and a battery, and be sure to conduct a periodic checking even after installation.

About Function of Running Speed Display

- If your vehicle is originally equipped with a speed warning light, please take note that its function will be lost with the installation of this meter. Please try to ride a motorcycle at legal speed on the public road, abiding by the law.
- Odometer (milometer)
- Maximum display speed is 250 km/h.

About Function of Engine Revolution Display

- This LCD tachometer is an electric tachometer which displays revolutions by reading firing pulses either by a high-tension cord or ignition coil, and its maximum display revolution is 30,000 rpm.

CAUTION The following show the envisioned possibility of injuries to human bodies or property damage as a result of disregarding the following cautions.

- Please try to ride a motorcycle at legal speed on the public road, abiding by the law.
- Work only when the engine and the muffler are cool. (Otherwise, you will burn yourself.)
- Prepare right tools for the work, and do the work in the proper and right way. (Otherwise, improper work could cause breakage of parts or injuries to yourself.)
- As some products and frames have sharp-pointed or protruding portions, please work with your hands protected. (Otherwise, you will suffer injuries.)
- Before riding, always check every section for slack in parts like screws. If you find slack ones, screw them securely up to the specified torque. (Or improper torque may cause parts to come off.)

WARNING The following show the envisioned possibility of human death or serious injuries to human bodies as a result of disregarding the following cautions.

- Always drive the engine in a well-ventilated place, and do not switch the engine on in an airtight place. (Otherwise, you will suffer from carbon monoxide poisoning.)
- Before doing work, place the motorcycle on level ground to stabilize the position of your motorcycle for safety's sake. (Otherwise, your motorcycle could fall down and injure you while you are working.)
- When you notice something abnormal with your motorcycle while riding down a road, stop riding immediately and park your motorcycle in a safe place. (Otherwise, the abnormality could lead to an accident.)
- Check or perform maintenance of parts correctly according to the procedures in the instruction manual or a service manual. (Improper checking or maintenance could lead to an accident.)
- If you find damaged parts when checking and performing maintenance, do not use these parts any longer, and replace them with new ones. (The continued use of these damaged parts as they are could lead to an accident.)
- As gasoline is highly flammable, never place it close to fire. Make sure that nothing flammable is near the gasoline. Since vaporized accumulation of gasoline is at the high risk of explosion, work in a well-ventilated place.

Please be informed that, mainly because of improvement in performance, design changes, and cost increase, the product specifications and prices are subject to change without prior notice.
 This manual should be retained for future reference.

~ Kit contains ~



No.	Parts Name	QTY
1	Meter assembly	1
2	Pick up cord B	1
3	Power cord	1
4	Pick up cord A	1
5	Meter sub cord	1
6	Speed meter stay	1
7	Heat shrinkable tube	1
8	Plain washer, 5mm	4
9	Spring washer, 5mm	2
10	Flange nut, 5mm	2

~ Installation Procedures ~

1. Remove two bolts on the front cover with an in-vehicle hex wrench (5mm), and disconnect the black 3P coupler for a speed meter cord.
2. Unscrew four bolts on the meter panel, and remove the speed meter cable by raising the meter cover off the fuel tank.
 Note that there is a collar between the meter cable and the speed meter cable. Incidentally, this collar will not be utilized for this kit, but keep it for future use.

3. Pull up the speed meter cord and remove the meter panel.
 Press the speed meter's retainers in, and take the speed meter out.

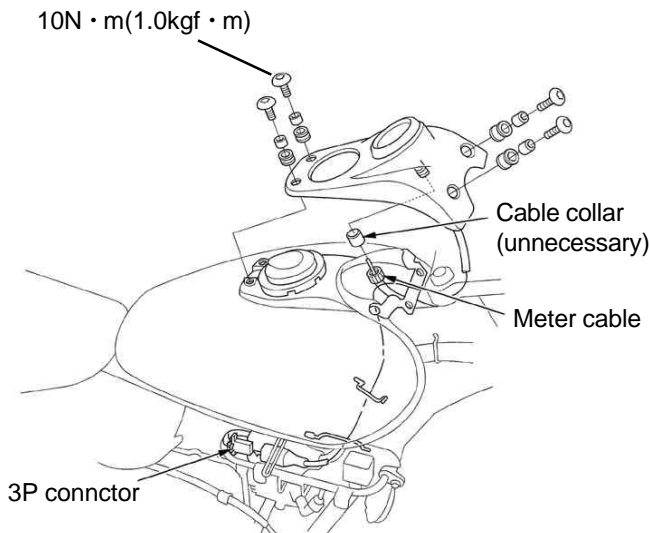
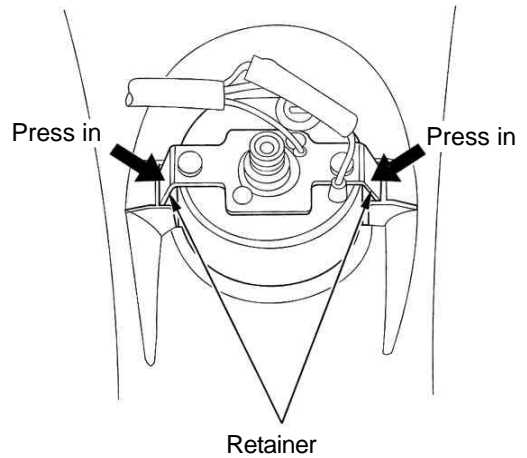

4. Detach mounting rubbers on the speed meter which please install to a kit's meter collar. Insert a kit's speed meter into the meter collar, which please set on the meter panel.
5. Fix the speed meter stay with spring washers and hex nuts.
6. Connect the meter cord's and sub cord's plugs and install the meter cover in the opposite order of removing it.
7. After installation, check that the pointer of the speed meter functions right.

Use a genuine meter rubber cushion. →

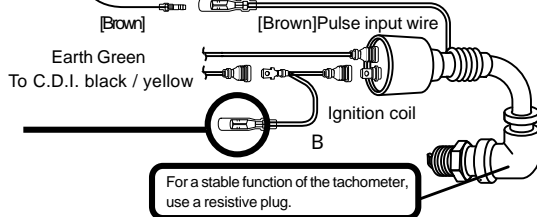
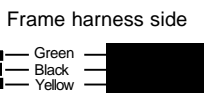
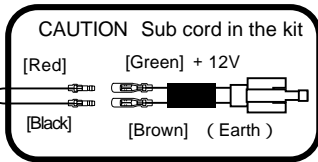
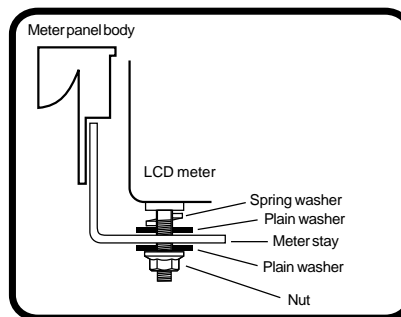
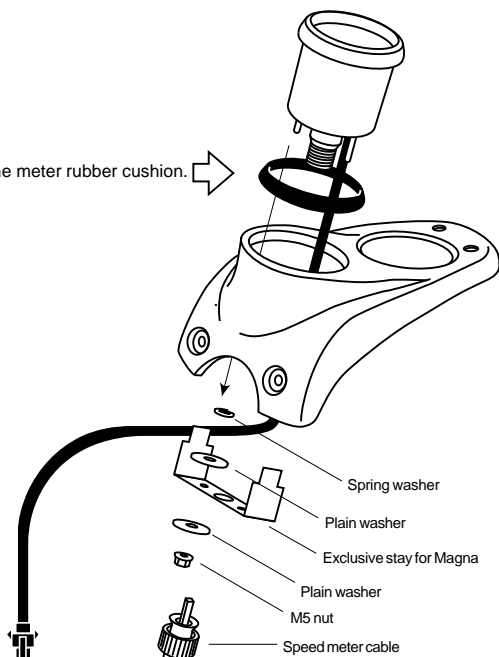

For a stable function of the tachometer, use a resistive plug.

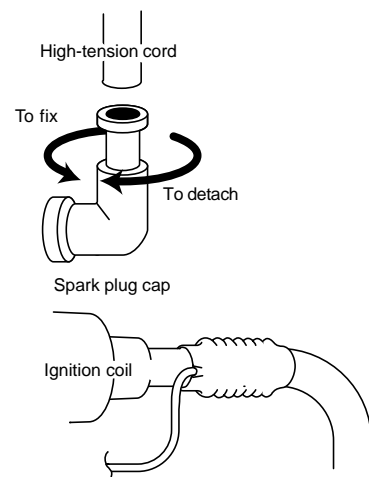

CAUTION

Colors of a kit's sub cord and a cord on the meter are different. Please be careful not connect wrong cords. Connecting of a + and a - plugs the other way round will result in the failure of the meter.

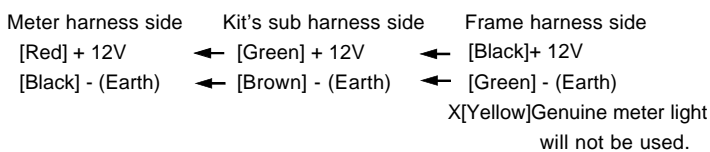

A, The way to wind around the high-tension cord

- Remove a plug cap from the high-tension cord.
- Wind the pick up cord A of the kit around the high-tension cord in about 5 circles, and temporarily fix it with an insulating tape or the like so that the wound cord does not loosen.
- Since a heat-shrinkable tube will be put through it later, be careful not to wind the insulating tube too much.
- Pass a heat-shrinkable tube through the section where the wound cord is temporarily fixed with a tape, and heat the tube to constrict it. Tube's constricting temperature is 90 or higher, and the tube is constricted to the extent of about 50% of its original inside diameter.
- Finally, reinstall the plug cap securely.

B, The way to directly connect to the ignition coil

CAUTION

Only when the tachometer malfunctions at the time of the engine rotating at high revolutions, input the power through a pick up cord B on the primary side.

SPECIAL PARTS TAKEGAWA Co.,Ltd.
 3-5-16 Nishikiorihigashi Tondabayashi Osaka Japan
 TEL : 81-721-25-1357 FAX : 81-721-24-5059
 URL : <http://www.takegawa.co.jp>

type Addendum

For tachometer set of large LCD meter

This page various kit common content.

Please switch the meter setting value according to appropriate vehicle.

Vehicle name	Product No.	CYC-	PIS-
MAGNA50	09-01-0211	2	1
ZOOMER (Carburetor vehicle)	09-01-0056	2	1
TODAY (Carburetor vehicle)	06-02-0303	2	1
AF62 Dio	06-02-0301	2	1
SPACY100	06-02-0305	2	1
Dio (two-cycle)	06-02-0302	2	1
JOG (two-cycle)	06-02-0304	2	1
XR50/100 Mptard	09-01-0288	2	1
XR250 Mptard	09-01-0055	2	1
KSR110	09-01-0054	2	1
KSR50/80	09-01-0054	2	2

Setting change procedure of tachometer

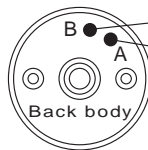

Numerical change button (in the text [B] button)
Setting item switch button (in the text [A] button)



Turn ON the main key of vehicle (starting the engine by vehicle), please state the power of meter has entered (there is a LCD).

Then press the [A]

Press the button on the [A].
Display of "CYC-" appears on the screen.
In this case, will change display alternately with the time you press the button on [B] "CYC-2" "CYC-4".



Numerical change in [B]

To fit to the appropriate vehicle, please select either.
After the selection of CYC- is now complete, please press

Then press the [A]

Display of "PIS-" appears on the screen.
In this case right side of numerals of the time you press the button on [B] "PIS-" will change.
Above - if you choose the "CYC 2" it will become a 1 2 3 4 1 2
It becomes 1 2 3 4 5 6 8 1 ... If also you have selected the "CYC-4".
Depending on appropriate vehicle, please select.



Numerical change in [B]

Then press the [A]

All settings are complete, it will return to standard screen from setting change screen by pressing [A] button.

Engine Type [CYC-], about number of cylinders [PIS-]

This [engine type, number of cylinders], an example of the ignition number of crankshaft rotation.
Therefore, some cases be different from engine type and the number of cylinders of actual vehicle.

0.5 times represents the once ignition to the crank shaft 2 rotation.

Ignition number of times per crankshaft revolution	0.5 times	1 times	1.5 times	2 times	2.5 times	3 times	4 times
CYC-2 (For example of two-cycle engine)		PIS-1		PIS-2		PIS-3	PIS-4
CYC-4 (For example of four-cycle engine)	PIS-1	PIS-2	PIS-3	PIS-4	PIS-5	PIS-6	PIS-8

(PIS- the example of the number of cylinders)

When ignition number of appropriate vehicle do not know
Engine types in [CYC-2] fixed, first set the number of cylinders in [PIS-4], please check the display numeric value by lightly blip the engine.

The number of cylinders [PIS-4] in because it is often actually displayed less than, we will display number is increased by changing the PIS-3 PIS-2 PIS-1 and numbers while watching a state, it becomes just a good set .

Monkey-based engine, Ape-based engine, other four-stroke 1 cylinder, many four-cylinder engine is set because it is one ignition per rotation crank shaft 1 will be [CYC-2, PIS-1].

In the part of the two-stroke one cylinder of vehicle and the inner rotor mounted vehicle, there is a case of ignition twice per crankshaft revolution [CYC-2, PIS-2].