



Aero jacket Instruction Manual for Under Fairing

Item No. : 09 - 09 - 0048

Applicable models and frame Nos:

Ape100 Type D : HC13-1000001 ~

- Thank you for purchasing one of our TAKEGAWA's products. You are requested to follow the below-mentioned instructions in installing this Kit.
- Before installation, please check the contents of this Kit. Should you have any questions about the product, please kindly contact your local dealer.

Please note that the descriptions in this manual like illustrations and photos may differ from the actual hardware.

Please read the following instructions before installation.

We do not take any responsibility for any accident or damage whatsoever arising from the use of the products not in conformity with the instructions in the manual.

We shall be held free from any kind of warranty whatsoever of products other than this product if the glitch takes place on the other products than this one after the installation and use of this product.

You are kindly requested not to contact us about the combination of our products with other manufacturers'.

This product is designed for exclusive use in the above-mentioned types of motorcycles and frame numbers only. Please take note that this product cannot be mounted on other types of motorcycles.

NEVER apply gasoline or thinner to the fenders when performing maintenance of them. Otherwise, the applied portion may deform or discolor.

The white and black gel coating of the FRP products is treated in the preceding processes, not in the final process. As a matter of principle, we paint all The FRP products.

As a result, when finishing treatment is given to the surface after treating the mottled portions or giving gel coating treatment, it sometimes happens that the gel coat layers are peeled off, exposing the plastic surface partly, which please note.

Before taking part in the racing with this product installed on your motorcycle, be sure to check the regulations beforehand.

With the installation of this product, the minimum ground clearance changes. So, adjust the fork or shock absorber so that the under fairing does not touch the ground when the fork or shock absorber hits the lowest point.

And beware of the big bump not to damage your motorcycle.

This product can be installed only when a correct exhaust system of 04-02-2804 for the above-mentioned motorcycle is installed.

CAUTION The following show the envisioned possibility of injuries to human bodies or property damage as a result of disregarding the following cautions.

- Work only when the engine and the muffler are cool.
(Otherwise, you will burn yourself.)
- Prepare right tools for the work, and do the work in the proper and right way.
(Otherwise, improper work could cause breakage of parts or injuries to yourself.)
- As some products and frames have sharp-pointed or protruding portions, please work with your hands protected.
(Otherwise, you will suffer injuries.)
- Before riding, always check every section for slack in parts like screws. If you find slack ones, screw them securely up to the specified torque.
(Or improper torque may cause parts to come off.)

WARNING The following show the envisioned possibility of human death or serious injuries to human bodies as a result of disregarding the following cautions.

- When you notice something abnormal with your motorcycle while riding down a road, stop riding immediately and park your motorcycle in a safe place. (Otherwise, the abnormality could lead to an accident.)
- Before doing work, place the motorcycle on level ground to stabilize the position of your motorcycle for safety's sake.
(Otherwise, your motorcycle could fall down and injure you while you are working.)
- Check or perform maintenance of parts correctly according to the procedures in the instruction manual or a service manual.
(Improper checking or maintenance could lead to an accident.)
- If you find damaged parts when checking and performing maintenance, do not use these parts any longer, and replace them with new ones.
(The continued use of these damaged parts as they are could lead to an accident.)

Please be informed that, mainly because of improvement in performance, design changes, and cost increase, the product specifications and prices are subject to change without prior notice.

This manual should be retained for future reference.

~ Kit Contents ~

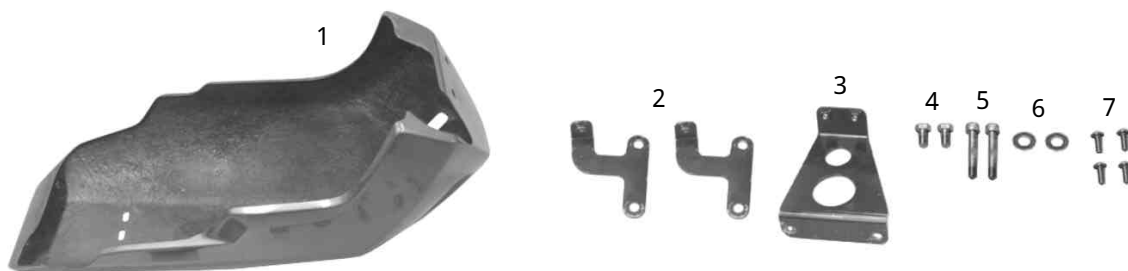

No.	Parts Name	Qty	Repair Part Item No.	in packs of
1	Under fairing	1	64460-GEY-T00	1
2	Under fairing bracket A	2	50127-GEY-T01	1
3	Under fairing bracket B	1	50126-GEY-T00	1
4	Flange bolt, 8X16	2	00-00-0039	4
5	Socket cap screw, 8X75	2	00-00-0296	2
6	Plain washer, 8mm	2	00-00-0076	10
7	Flange button head socket screw, 6X12	4	00-00-0293	2

Please note that in ordering repair parts, be sure to quote the Repair Part Item No. Otherwise, we may not be able to accept your orders. There are some parts, however, for which we are not in a position to accept your order in just the quantity to be used. In this case, please take them in the quantity packed.

~ Installation Procedures ~

- 1 . Secure the motorcycle on a rear service stand.
Support the bottom of the engine with a jack.

△ NOTE : In installing the parts, adjust the height of the jack to free the mounting bolts and others of the load.



- 2 . Remove two mounting bolts indicated by arrows, and install the under fairing bracket A.
Beware of the direction of the installation. Install referring to the photos below.

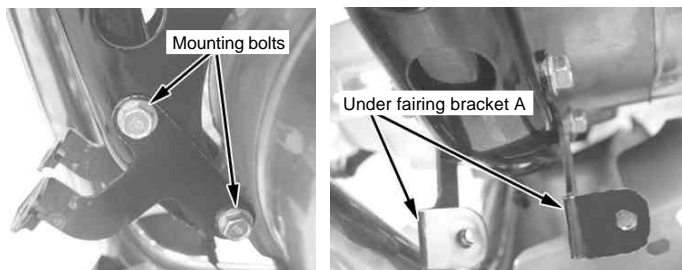

In installing our aluminum engine hanger, replace the bracket-mounting bolt with an included 8 x 75 socket cap screw and 8mm plain washer. Retighten the loosened bolt.
Torque: 26 N·m (2.7 kgf·m)

- 3 . Then, remove the jack supporting the bottom of the engine.
And install the under fairing bracket B onto the bolt hole in the rear part of the engine bottom, using an 8 x 16 flange bolt.
When installing the bracket, beware of its right direction.
Install it referring to the photos below.

Torque: 12 N·m (1.2 kgf·m)

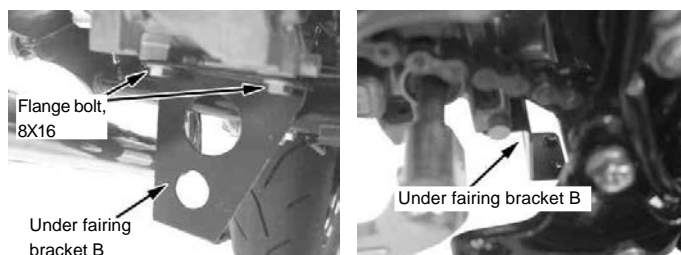

- 4 . Install the under fairing with a 6 x 12 flange button head socket screw.
Torque: 6 N·m (0.6 kgf·m)
△ NOTE : The paintwork may peel off at the time of screw-tightening.

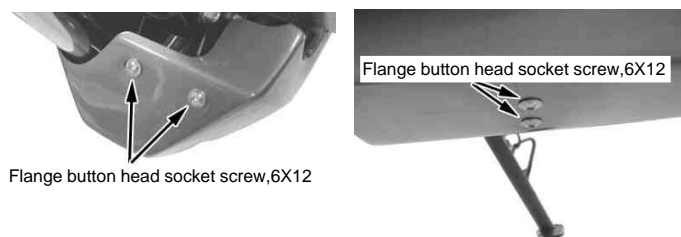

- 5 . If the oil cooler is connected to the clutch cover, route and install the oil lines referring to the photos below.

